

**Road Prgram Year**

- 2016
- 2017
- 2018
- 2019
- 2020
- 2021
- 2022
- 2023
- 2024
- 2025
- 2026
- 2027
- 2028
- 2029
- 2030

**GHA** GEWALT HAMILTON  
ASSOCIATES, INC.  
www.gha-engineers.com

# 15-Year Road Program By Scheduled Year

## Village of Wadsworth, Illinois

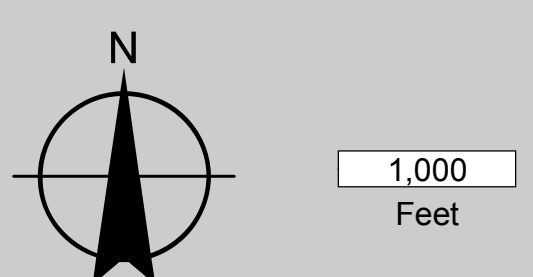

Sources: Lake County GIS

File: G:\4250\4250 Wadsworth\4250-1111517-RoadProgram ByYear\_24x36.mxd  
Drawn By: grawton

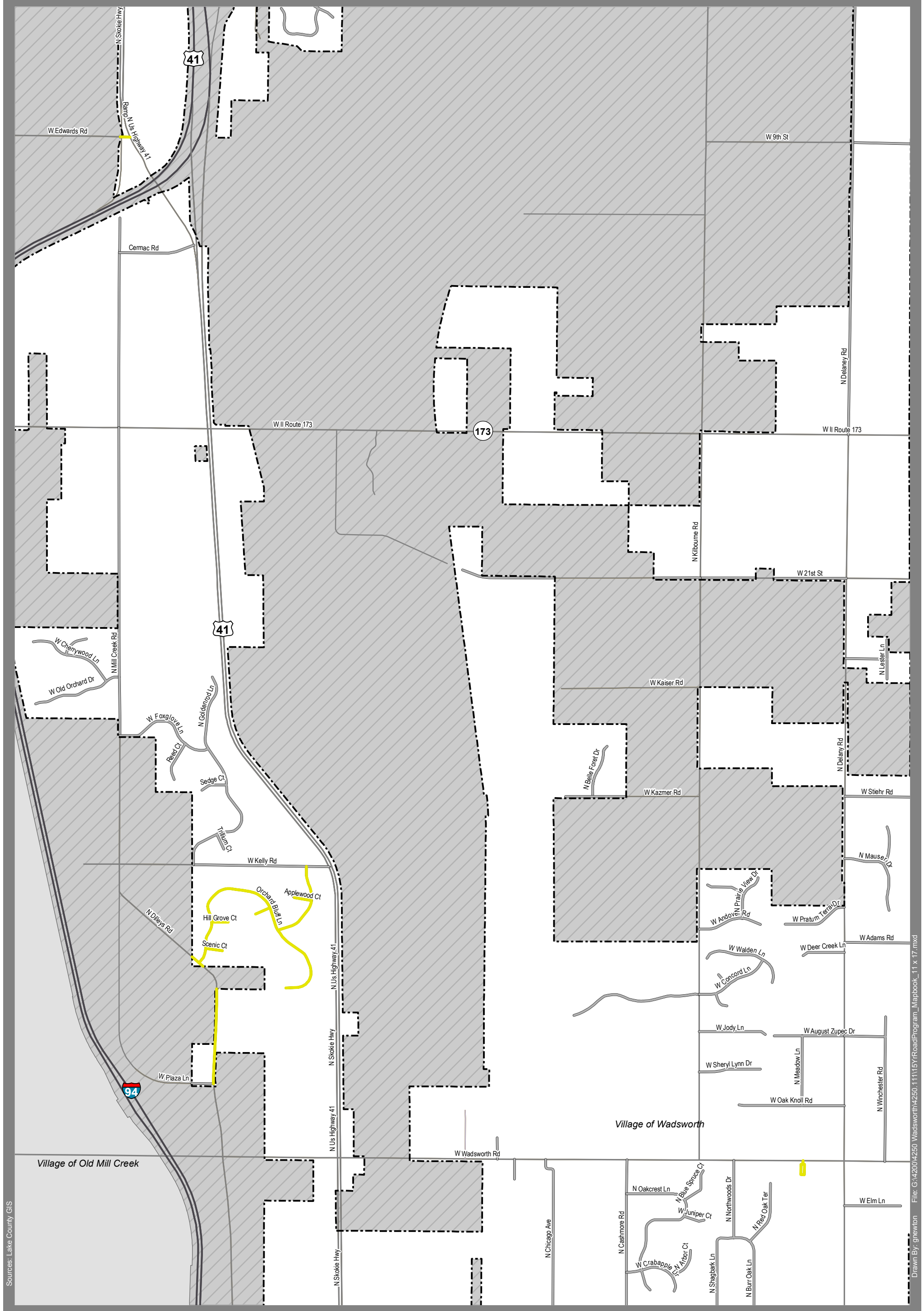

Sources: Lake County GIS

File: G:\4200\4250 Wadsworth\4250\_111151RoadProgram\_Mapbook\_11 x 17.mxd  
 Drawn By: gnewton



1 inch = 1,500 Feet

**Legend**

- 2016 Program
- Other Road Program Segments

**Road Program Year 2016**  
 Village of Wadsworth, IL

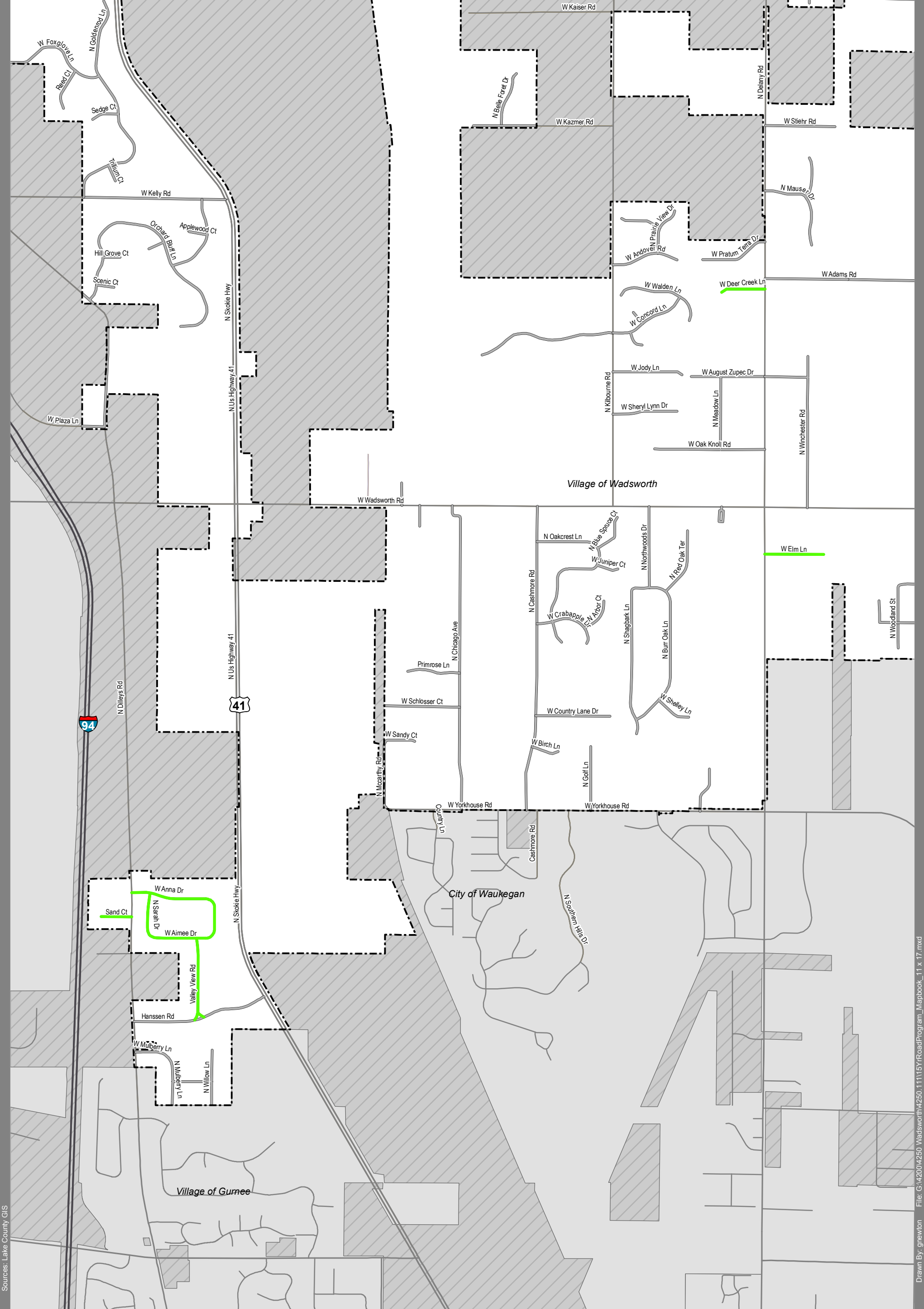

Sources: Lake County GIS

Drawn By: gnewton File: G:\4200\4250 Wadsworth\4250\_111151RoadProgram\_Mapbook\_11 x 17.mxd

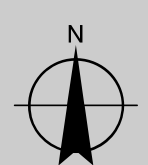

1 inch = 1,500 Feet

**Legend**

- 2017 Program
- Other Road Program Segments

**Road Program Year 2017**  
Village of Wadsworth, IL

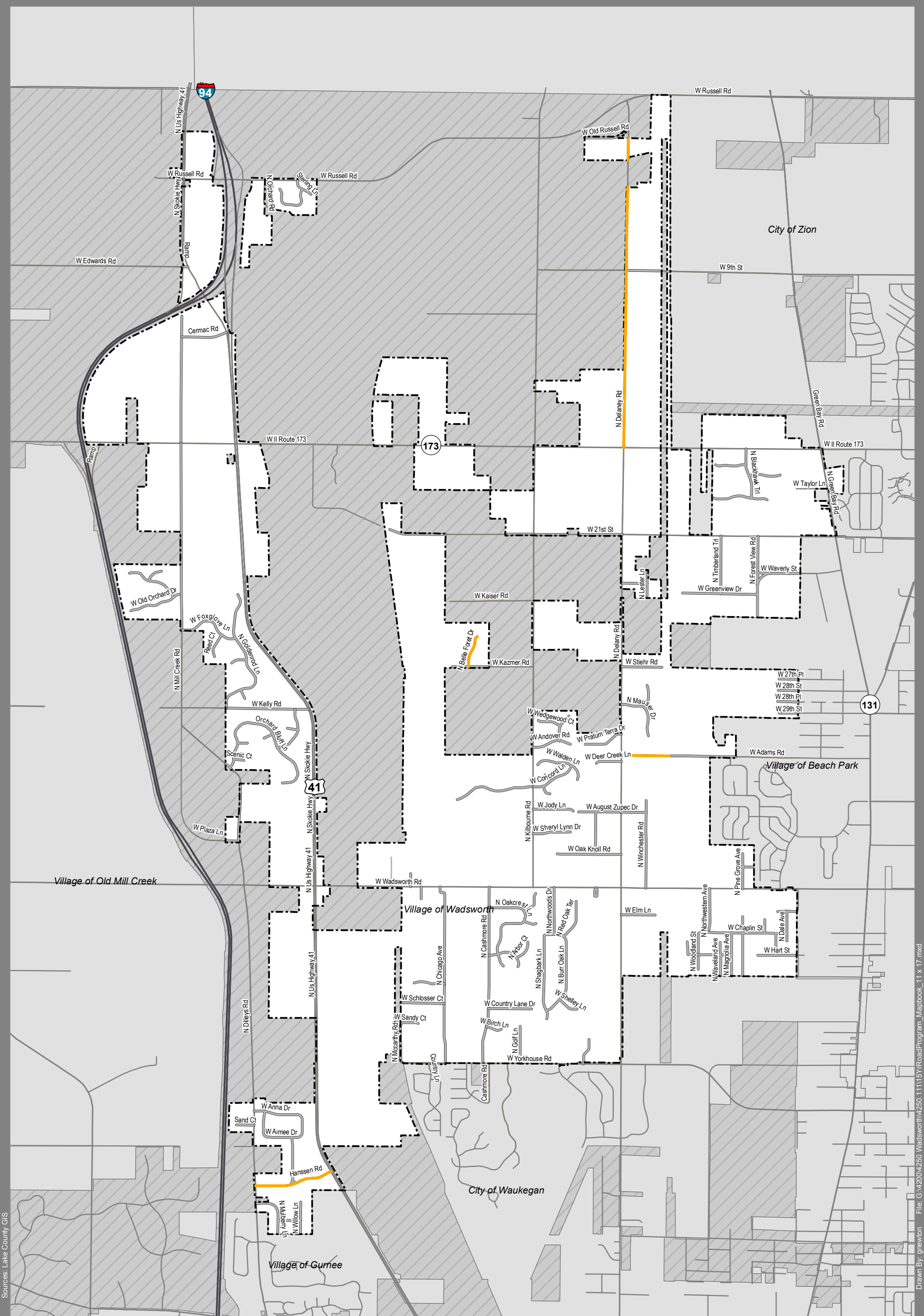

1 inch = 2,600  
Feet

**Legend**

- 2018 Program
- Other Road Program Segments

# Road Program Year 2018

## Village of Wadsworth, IL

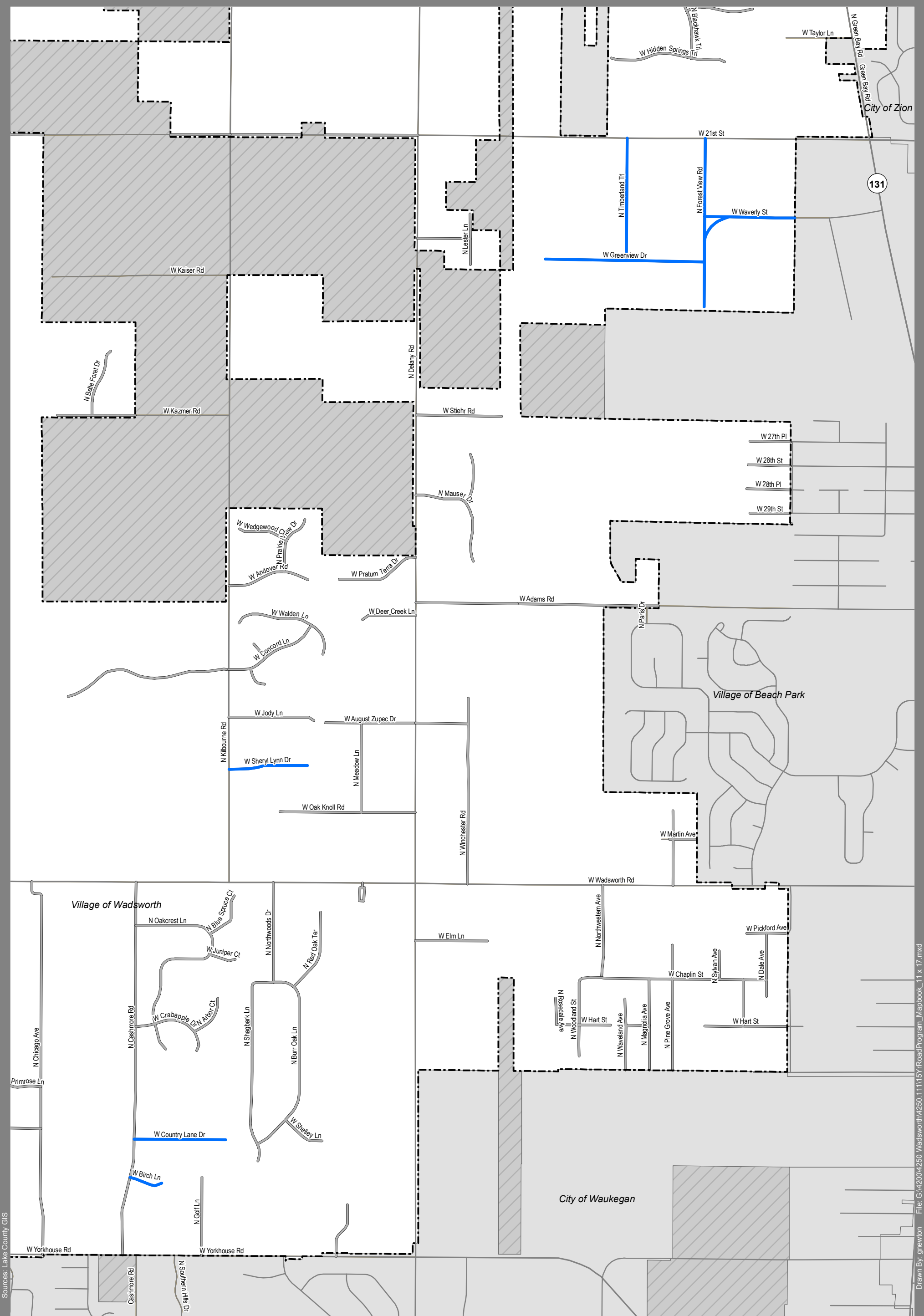

Sources: Lake County GIS

Drawn By: gnewton File: G:\4200\4250 Wadsworth\4250\_111151RoadProgram\_Mapbook\_11 x 17.mxd

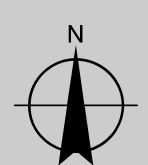

1 inch = 1,200 Feet

**Legend**

- 2019 Program
- Other Road Program Segments

# Road Program Year 2019

## Village of Wadsworth, IL

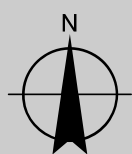
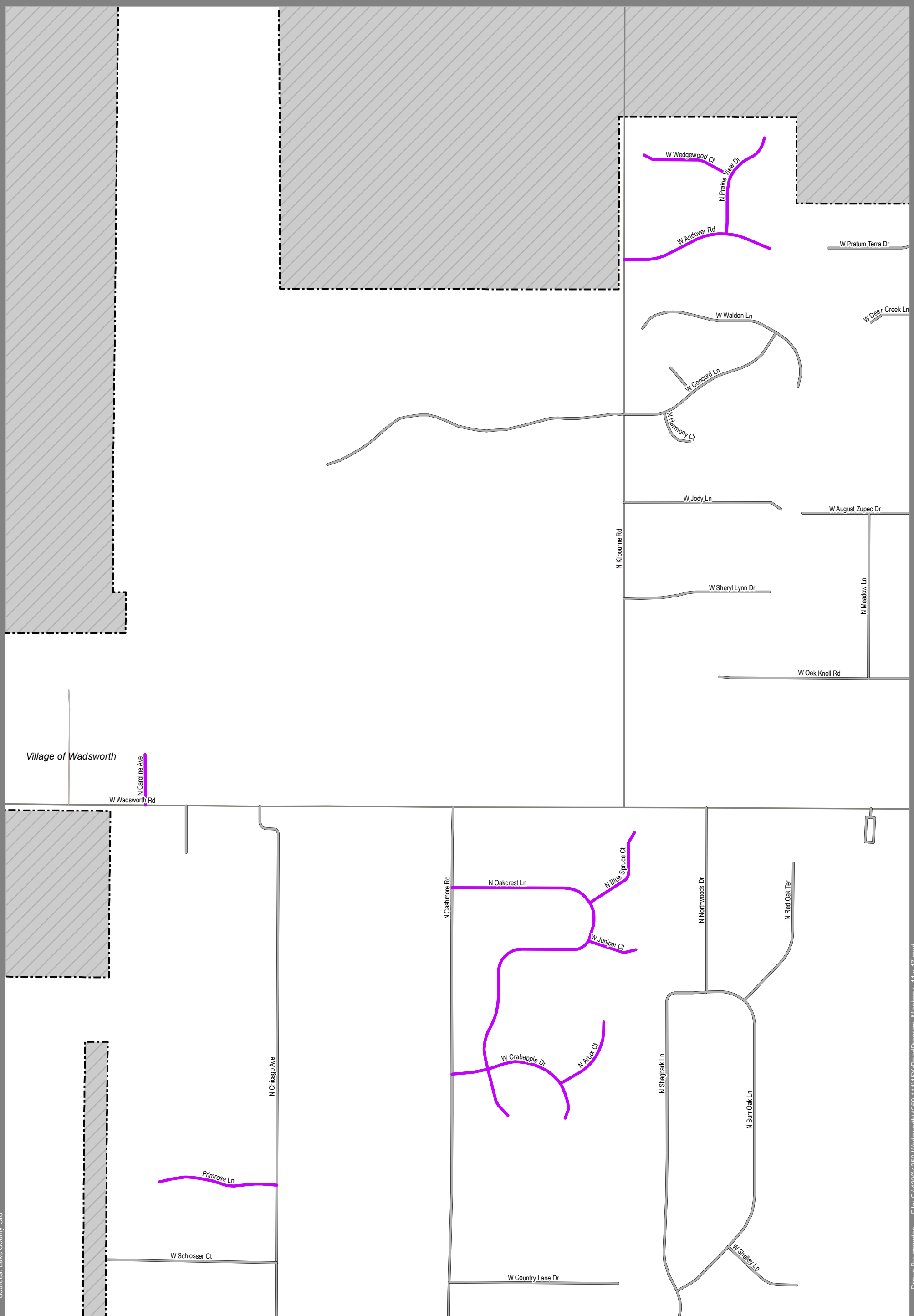

1 inch = 670  
Feet

**Legend**

- 2020 Program
- Other Road Program Segments

# Road Program Year 2020

## Village of Wadsworth, IL

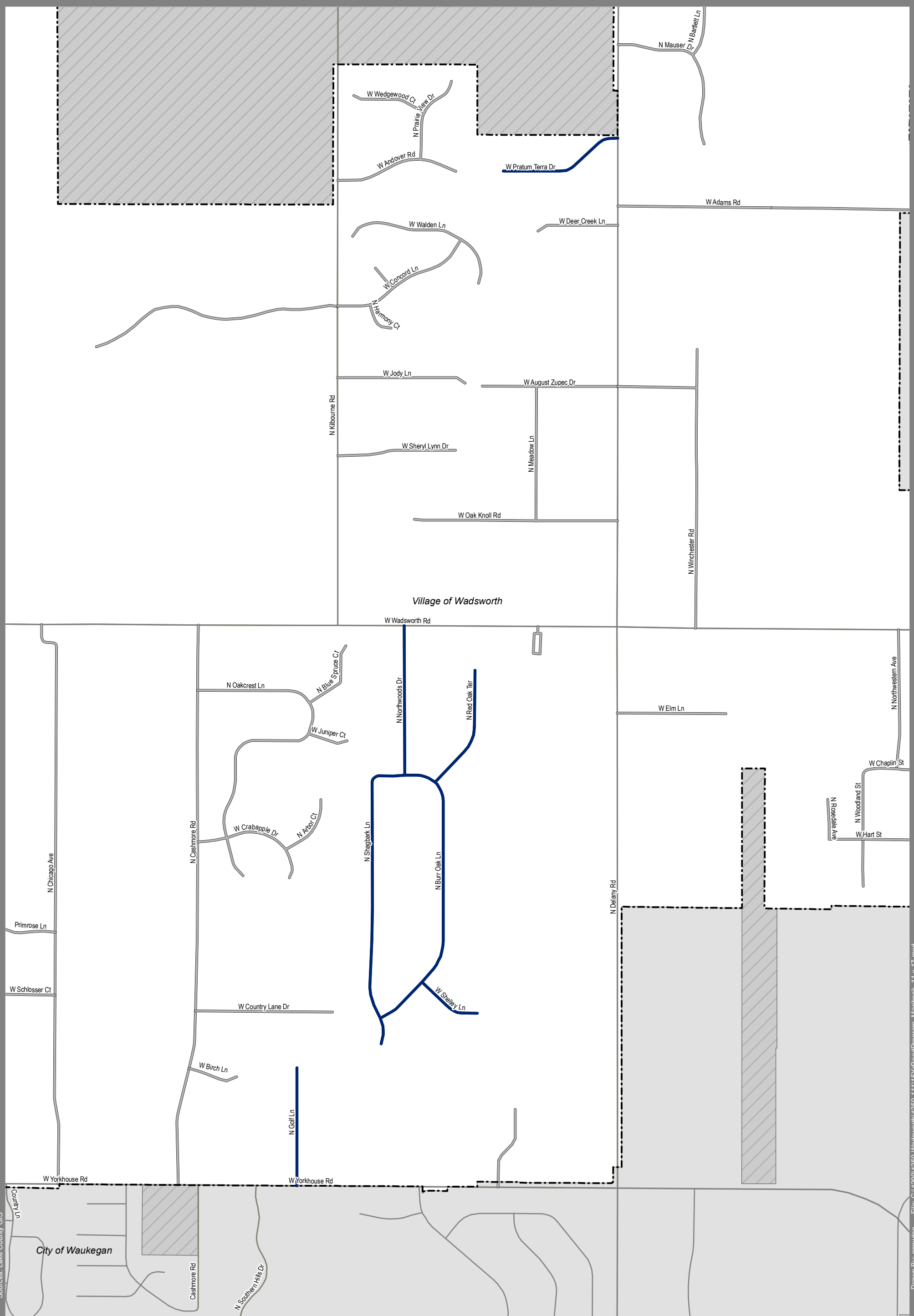

Village of Wadsworth

W Wadsworth Rd

N Northwoods Dr

N Reed Oak Ter

N Burr Oak Ln

N Shepley Ln

W Elm Ln

W Chaplin St

N Rosedale Ave

N Woodland St

W Hart St

N Chicago Ave

Primrose Ln

W Schlosser Ct

N Cashmore Rd

N Oakcrest Ln

N Blue Spruce Ct

W Juniper Ct

W Crabapple Dr

N Arbor Ct

W Country Lane Dr

W Birch Ln

N Golf Ln

W Yorkhouse Rd

N Delany Rd

N Delany Rd

N Northwestern Ave

W Elm Ln

W Chaplin St

N Rosedale Ave

N Woodland St

W Hart St

N Chicago Ave

Primrose Ln

W Schlosser Ct

N Cashmore Rd

N Oakcrest Ln

N Blue Spruce Ct

W Juniper Ct

W Crabapple Dr

N Arbor Ct

W Country Lane Dr

W Birch Ln

N Golf Ln

W Yorkhouse Rd

N Delany Rd

N Delany Rd

N Northwestern Ave

W Elm Ln

W Chaplin St

N Rosedale Ave

N Woodland St

W Hart St

N Chicago Ave

Primrose Ln

W Schlosser Ct

N Cashmore Rd

N Oakcrest Ln

N Blue Spruce Ct

Sources: Lake County GIS

File: G:\4200\4250 Wadsworth\4250\_11115YRoadProgram\_Mapbook\_11 x 17.mxd

Drawn By: gnewton

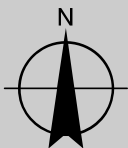

1 inch = 825 Feet

**Legend**

- 2021 Program
- Other Road Program Segments

# Road Program Year 2021

## Village of Wadsworth, IL

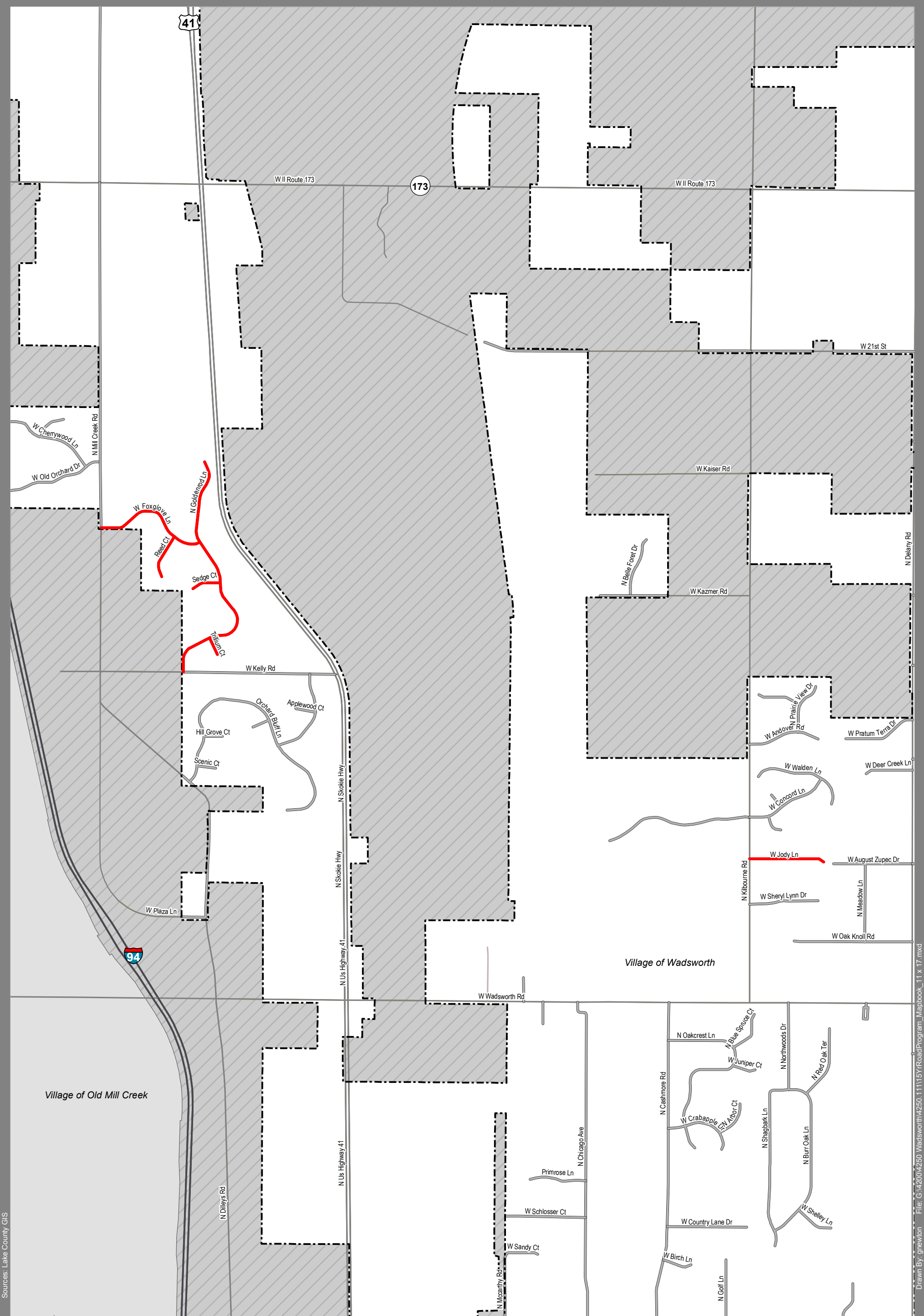

Sources: Lake County GIS

File: G:\4200\4250 Wadsworth\4250\_111151RoadProgram\_Mapbook\_11 x 17.mxd

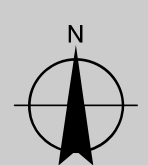

1 inch = 1,400 Feet

**Legend**

- 2022 Program
- Other Road Program Segments

# Road Program Year 2022

## Village of Wadsworth, IL



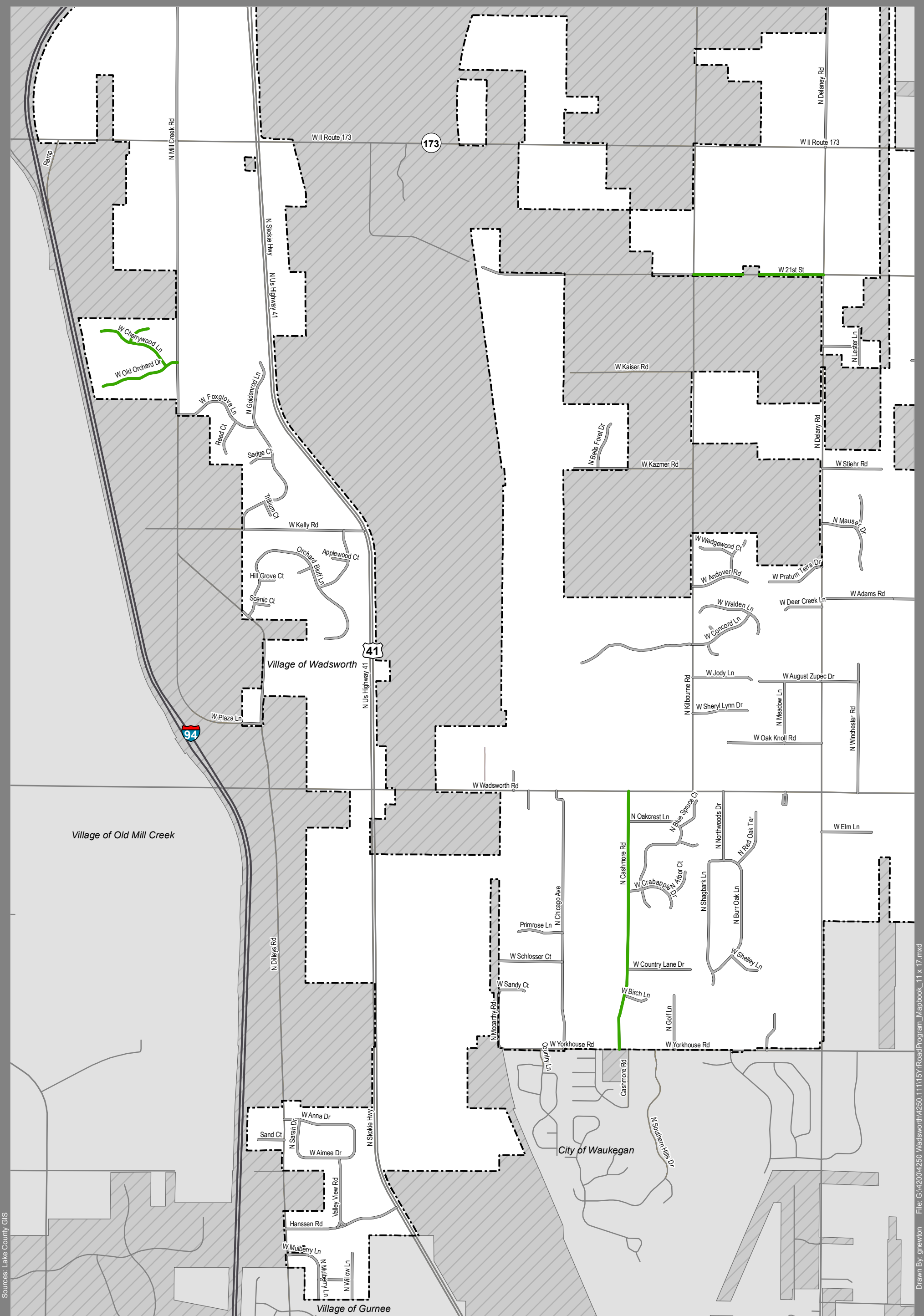

Sources: Lake County GIS

File: G:\4200\4250 Wadsworth\4250\_111515RoadProgram\_Mapbook\_11 x 17.mxd

Drawn By: gnewton



1 inch = 1,750 Feet

**Legend**

- 2023 Program
- Other Road Program Segments

# Road Program Year 2023

## Village of Wadsworth, IL

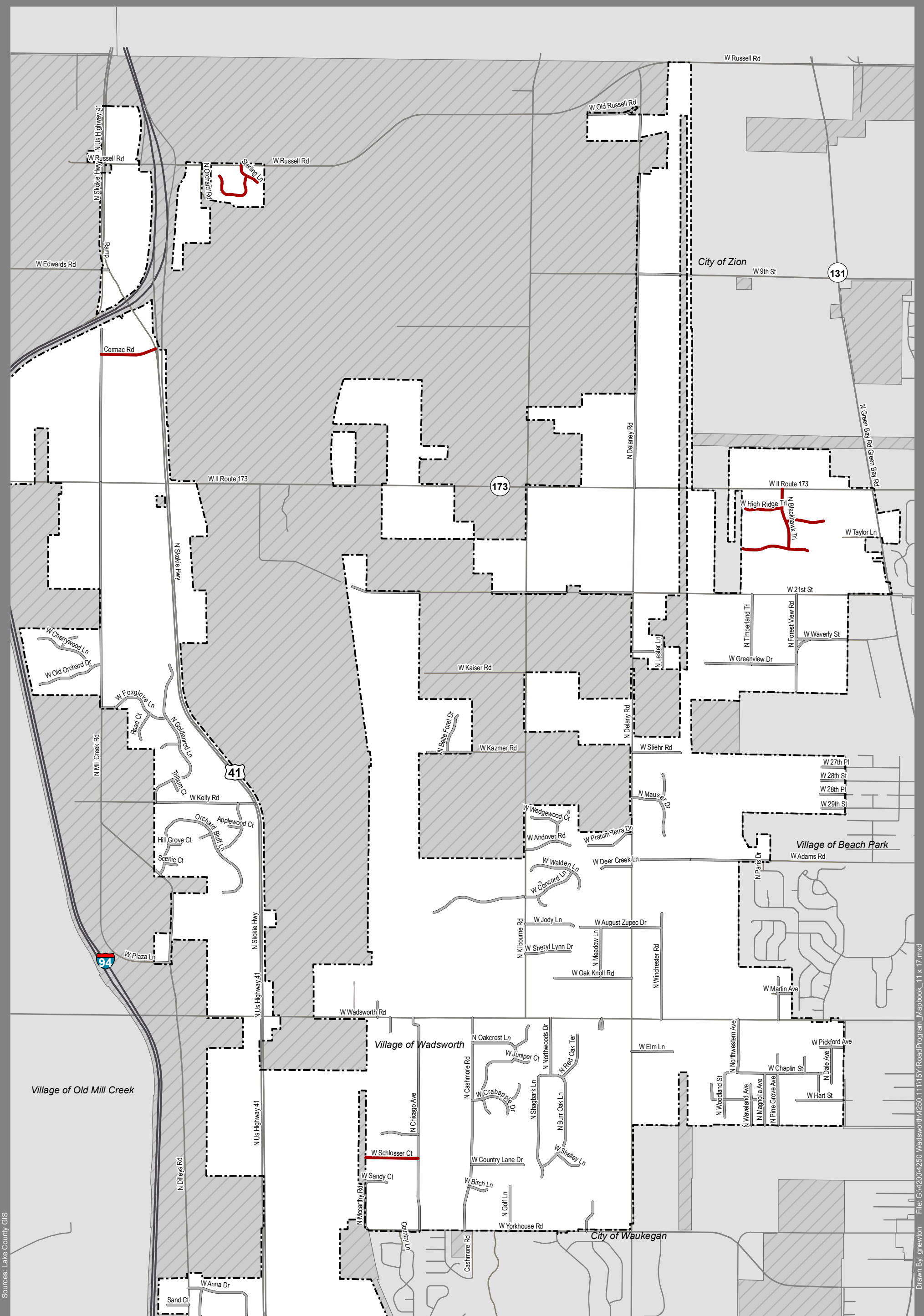

Sources: Lake County GIS

File: G:\4200\4250 Wadsworth\4250\_111151RoadProgram\_Mapbook\_11 x 17.mxd

Drawn By: gnewton

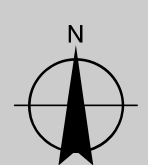

1 inch = 2,100 Feet

**Legend**

- 2024 Program
- Other Road Program Segments

# Road Program Year 2024

## Village of Wadsworth, IL

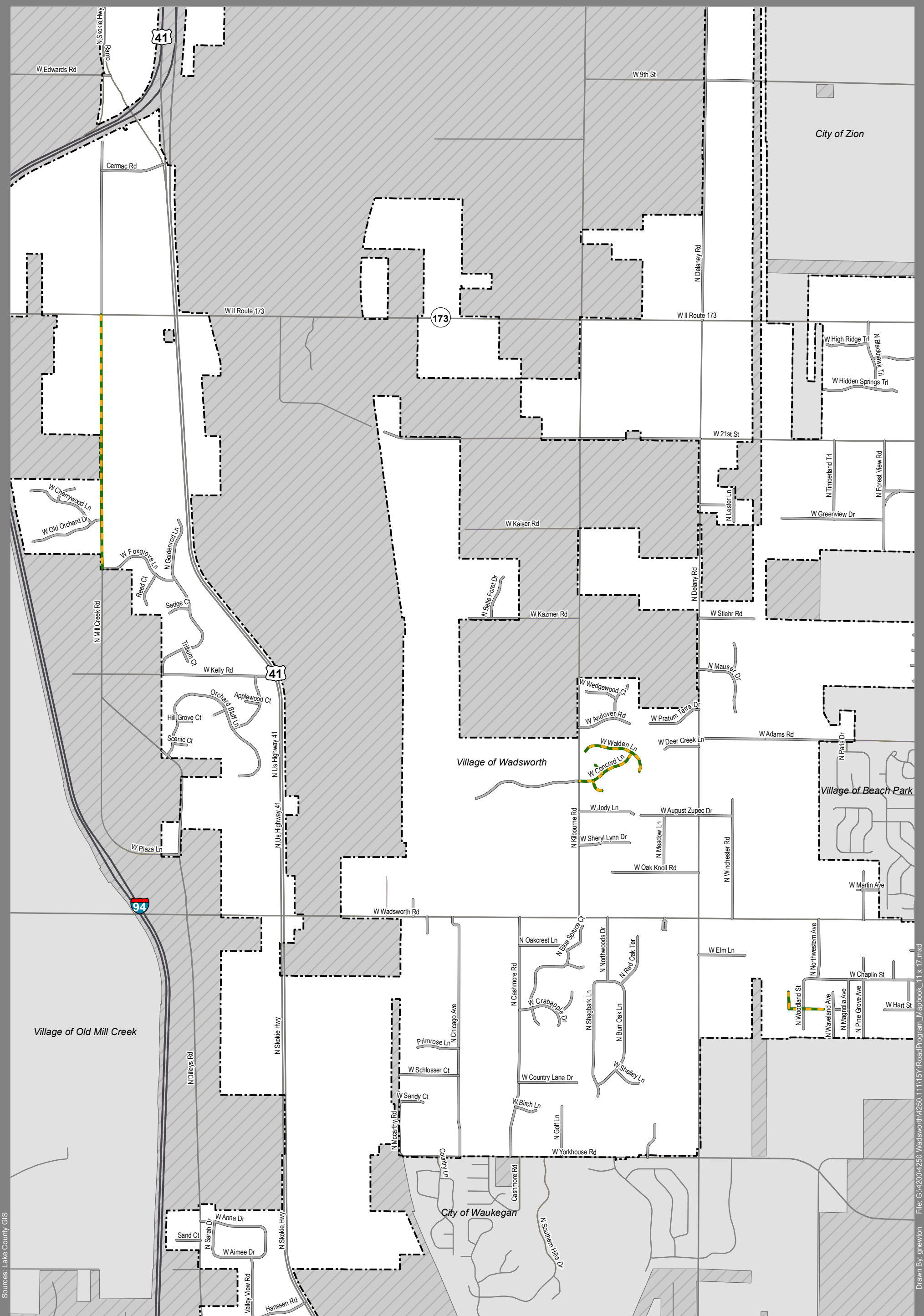

Sources: Lake County GIS

File: G:\4200\4250 Wadsworth\4250\_111151RoadProgram\_Mapbook\_11 x 17.mxd

Drawn By: gnewton

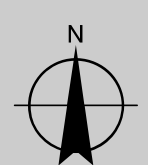

1 inch = 1,900 Feet

**Legend**

- 2025 Program
- Other Road Program Segments

# Road Program Year 2025

## Village of Wadsworth, IL

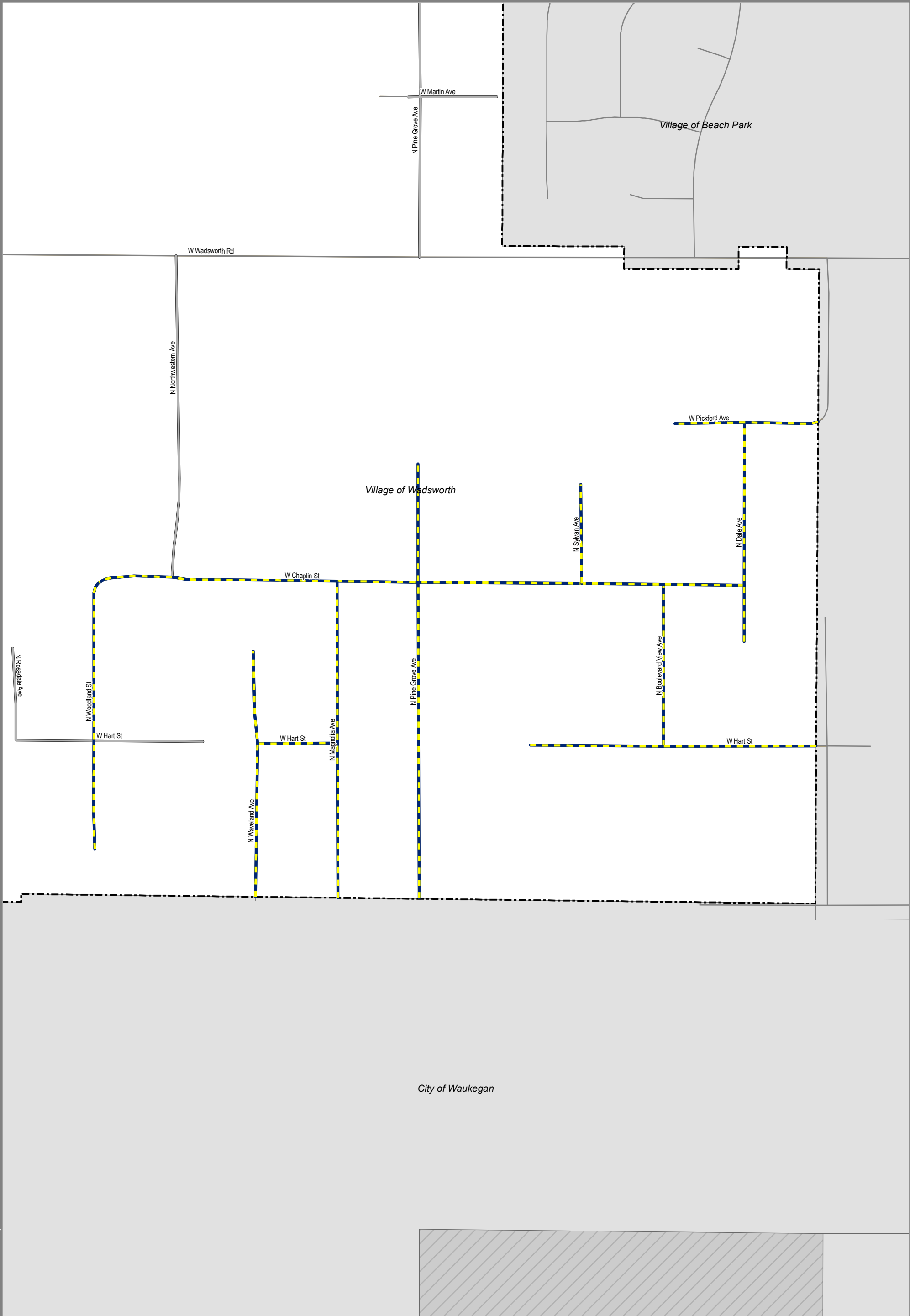

1 inch = 350  
Feet

**Legend**

- 2026 Program
- Other Road Program Segments

**Road Program Year 2026**  
Village of Wadsworth, IL

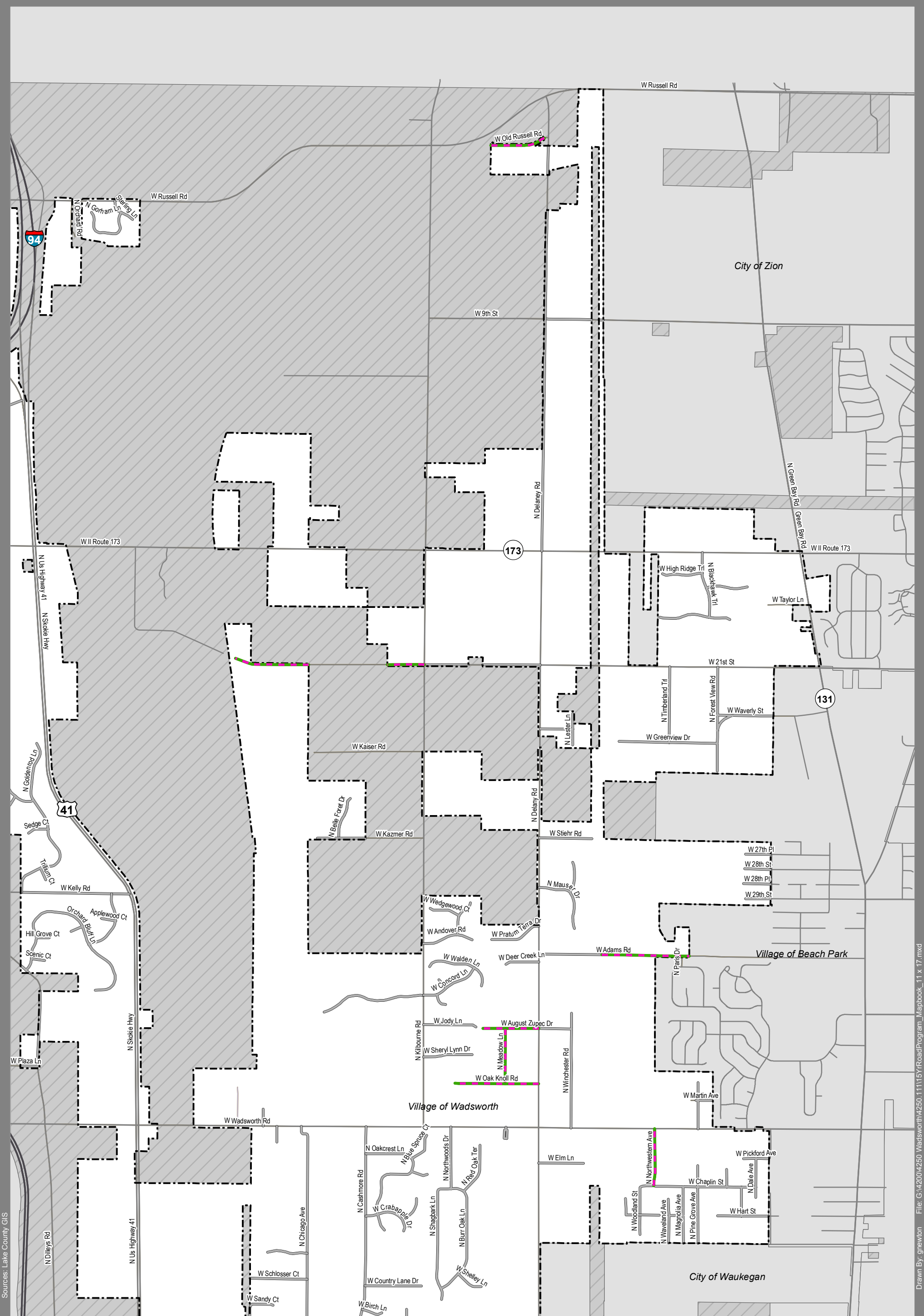

Sources: Lake County GIS

Drawn By: gnewton File: G:\4200\4250 Wadsworth\4250\_111151RoadProgram\_Mapbook\_11 x 17.mxd

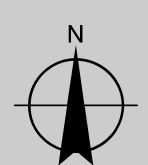

1 inch = 2,000 Feet

**Legend**

- 2027 Program
- Other Road Program Segments

# Road Program Year 2027

## Village of Wadsworth, IL

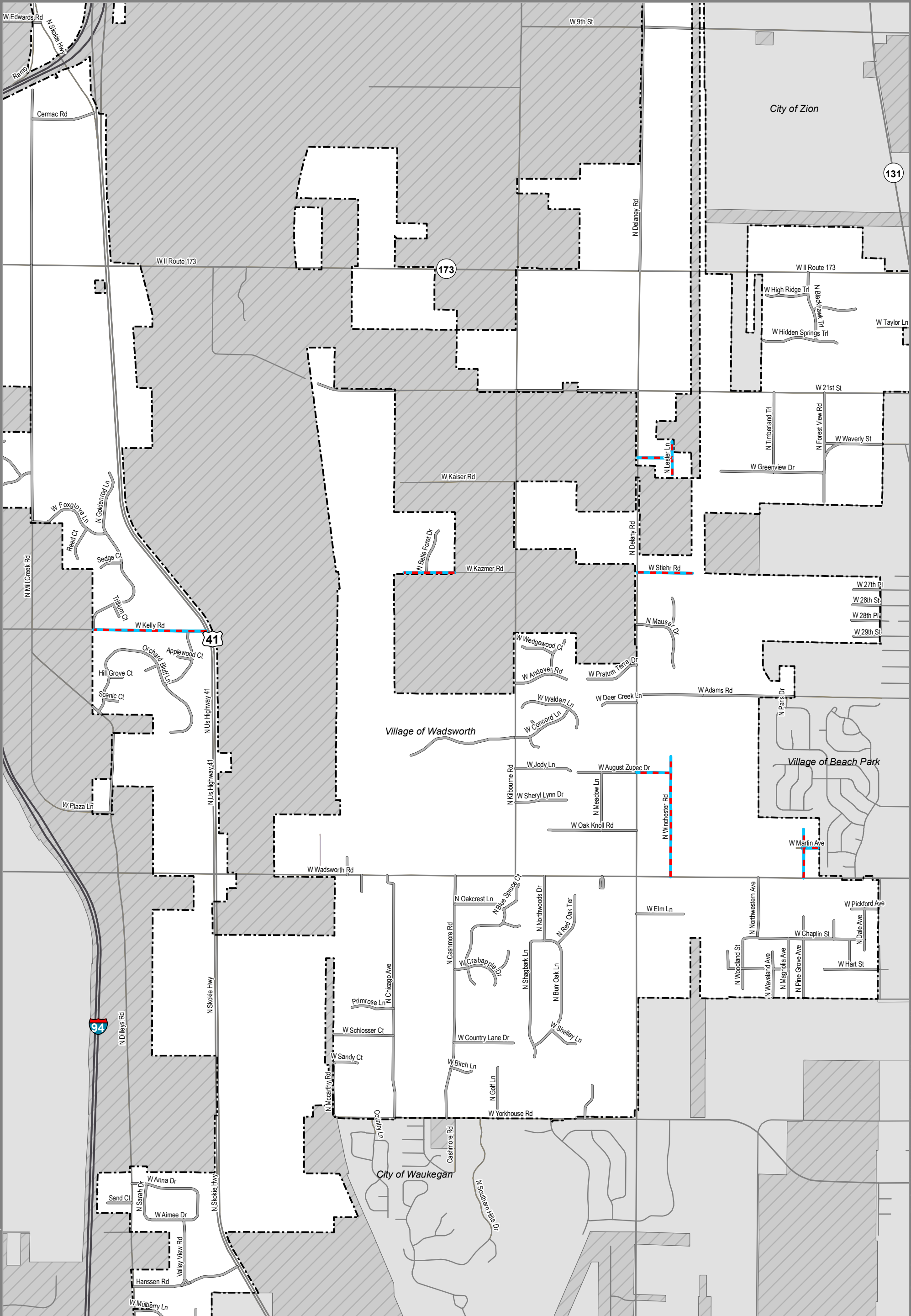

Sources: Lake County GIS

File: G:\4200\4250 Wadsworth\4250\_111151RoadProgram\_Mapbook\_11 x 17.mxd



1 inch = 1,900 Feet

**Legend**

- 2028 Program
- Other Road Program Segments

# Road Program Year 2028

## Village of Wadsworth, IL

Drawn By: gnewton

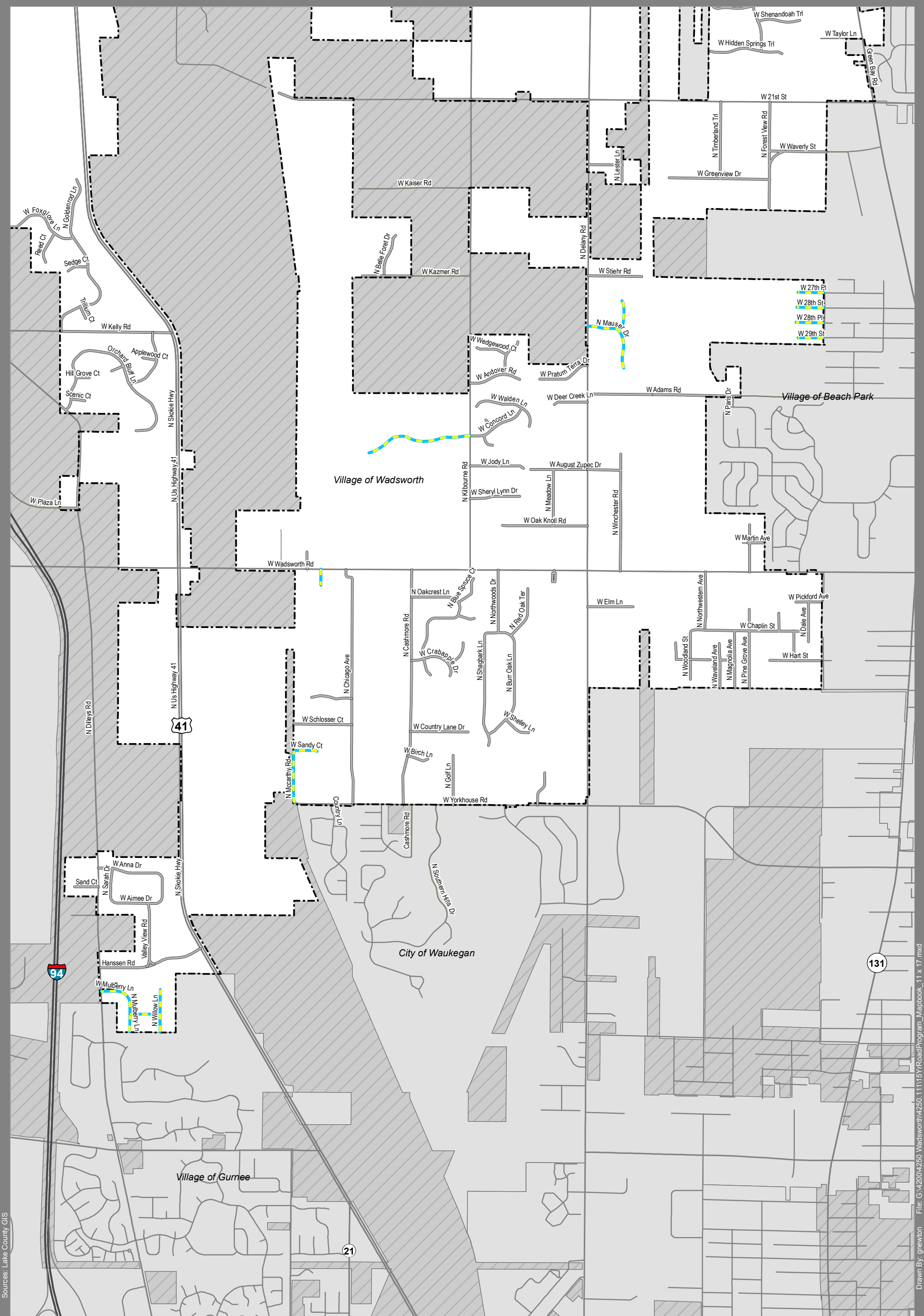

Sources: Lake County GIS

File: G:\4200\4250 Wadsworth\4250\_111151RoadProgram\_Mapbook\_11 x 17.mxd  
 Drawn By: grewton

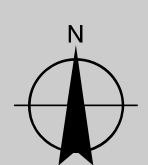

1 inch = 1,900 Feet

**Legend**

- 2029 Program
- Other Road Program Segments

**Road Program Year 2029**  
 Village of Wadsworth, IL

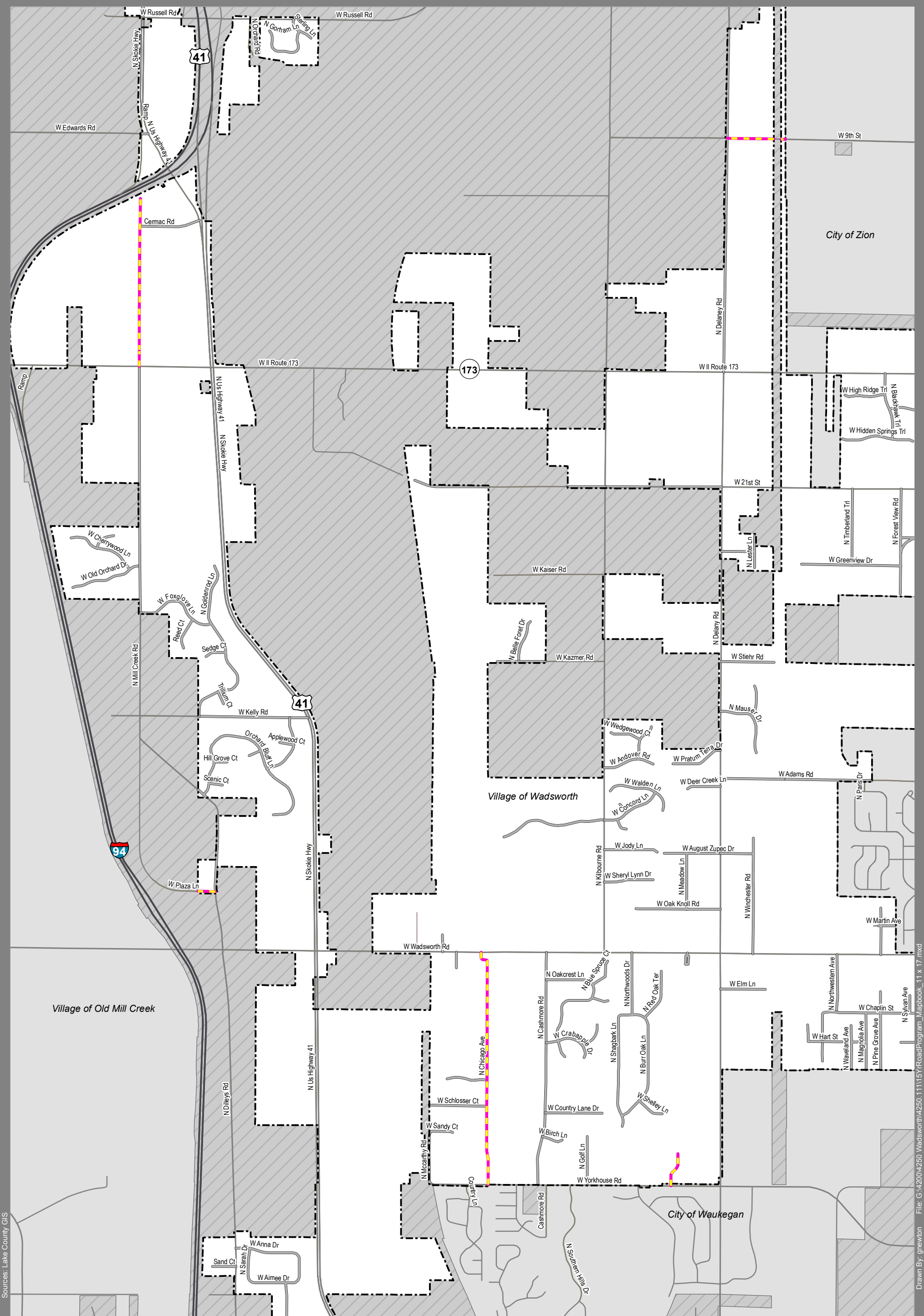

Sources: Lake County GIS

Drawn By: gnewton File: G:\4200\4250 Wadsworth\4250\_111151RoadProgram\_Mapbook\_11 x 17.mxd

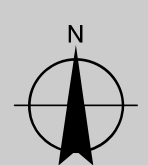

1 inch = 2,000 Feet

**Legend**

- 2030 Program
- Other Road Program Segments

# Road Program Year 2030

## Village of Wadsworth, IL



**PROGRAMMED IMPROVEMENTS  
VILLAGE OF WADSWORTH  
0 ROAD PROGRAM**



<b>Street</b>	<b>From To</b>	<b>Length(ft)</b>	<b>Width</b>	<b>Area (sy)</b>	<b>PCR</b>	<b>2015 Rehabilitation Cost</b>	<b>0<sup>*</sup> Rehabilitation Cost</b>
Village Hall Parking Lot	Wadsworth Road Wadsworth Road				0		

5 % Annual Inflation Compounded:

Construction Cost:

8 % Engineering:

7 % Contingency:

**Total:**

\_\_\_\_\_

\_\_\_\_\_

**PROGRAMMED IMPROVEMENTS  
VILLAGE OF WADSWORTH  
2016 ROAD PROGRAM**



Street	From To	Length(ft)	Width	Area (sy)	PCR	2015	2016 <sup>*</sup>
						Rehabilitation Cost	Rehabilitation Cost
Applewood Court	Jonathan Knolls Lane Cul-de-Sac	432	22	1056	70.2	\$33,792.00	\$35,482.00
Dilleys Road	160' North of Orchard Bluff 100' South of Orchard Bluff	260	23	664.4	89	\$21,261.00	\$22,324.00
Dilleys Road	Plaza Lane North to Village Limit	1793	22	4382.9	82.3	\$140,253.00	\$147,265.00
Edwards Road	Old 41/Skokie Highway West to Village Limit	120	23	306.7	64.7	\$9,814.00	\$10,305.00
Hill Grove Court	Orchard Bluff Lane Cul-de-Sac	391	20	868.9	79.2	\$27,805.00	\$29,195.00
Jonathan Knolls Lane	Kelly Road Orchard Bluff Lane	1339	23	3421.9	65.9	\$109,501.00	\$114,976.00
Macintosh Court	Orchard Bluff Lane Cul-de-Sac	399	22	975.3	82.2	\$31,210.00	\$32,770.00
Orchard Bluff Lane	Dilleys Road Cul-de-Sac	4554	22	11132	72.7	\$356,224.00	\$374,035.00
Scenic Court	Orchard Bluff Lane Cul-de-Sac	421	19	888.8	82.2	\$28,442.00	\$29,864.00

**PROGRAMMED IMPROVEMENTS  
VILLAGE OF WADSWORTH  
2016 ROAD PROGRAM**



Street	From To	Length(ft)	Width	Area (sy)	PCR	<b>2015</b> Rehabilitation Cost	<b>2016</b> <sup>*</sup> Rehabilitation Cost
5 % Annual Inflation Compounded:							\$37,914.00
Construction Cost:						\$758,302.00	\$796,216.00
8 % Engineering:						\$60,664.16	\$63,697.28
7 % Contingency:						\$53,081.14	\$55,735.12
<b>Total:</b>						<b>\$872,047.30</b>	<b>\$915,648.40</b>

**PROGRAMMED IMPROVEMENTS  
VILLAGE OF WADSWORTH  
2017 ROAD PROGRAM**



<b>Street</b>	<b>From To</b>	<b>Length(ft)</b>	<b>Width</b>	<b>Area (sy)</b>	<b>PCR</b>	<b>2015 Rehabilitation Cost</b>	<b>* 2017 Rehabilitation Cost</b>
Aime Lane	Sarah Drive Charolotte Drive	937	22	2290.4	76.2	\$73,293.00	\$80,805.00
Anna Drive	Dilleys Road Charolotte Drive	1270	22	3104.4	74.2	\$99,341.00	\$109,523.00
Charlotte Drive	Aimee Lane Anna Drive	860	22	2102.2	76.2	\$67,270.00	\$74,166.00
Deer Creek Lane	Delany Road Cul-de-Sac	882	23	2254	73.6	\$72,128.00	\$79,521.00
Elm Lane	Delany Road Cul-de-Sac	1128	21	2632	73.4	\$84,224.00	\$92,857.00
Hanssen Road	Dilleys Road US Route 41	2287	21	5336.3	83.3	\$170,762.00	\$188,265.00
Sand Court	Dilleys Road Cul-de-Sac	674	22	1647.6	81	\$52,723.00	\$58,127.00
Sarah Drive	Aimee Lane Anna Drive	775	22	1894.4	76.2	\$60,621.00	\$66,834.00
Valley View Road	Hanssen Road Aimee Drive	1501	22	3669.1	87	\$117,411.00	\$129,446.00

**PROGRAMMED IMPROVEMENTS  
VILLAGE OF WADSWORTH  
2017 ROAD PROGRAM**



Street	From To	Length(ft)	Width	Area (sy)	PCR	<b>2015</b> Rehabilitation Cost	<b>2017</b> <sup>*</sup> Rehabilitation Cost	
5 % Annual Inflation Compounded:							\$81,771.00	
Construction Cost:							\$797,773.00	\$879,544.00
8 % Engineering:							\$63,821.84	\$70,363.52
7 % Contingency:							\$55,844.11	\$61,568.08
<b>Total:</b>						<b>\$917,438.95</b>	<b>\$1,011,475.60</b>	

**PROGRAMMED IMPROVEMENTS  
VILLAGE OF WADSWORTH  
2018 ROAD PROGRAM**



Street	From To	Length(ft)	Width	Area (sy)	PCR	2015 Rehabilitation Cost	2018 <sup>*</sup> Rehabilitation Cost
Adams Road	Delany Road RR Tracks	1584	24	4224	75.3	\$135,168.00	\$156,474.00
Belle Foret Drive	Kazmer Road Cul-de-Sac	1099	20	2442.2	74.8	\$78,150.00	\$90,469.00
Delany Road	IL Route 173 9th Street	5174	22	12647.6	81.1	\$404,723.00	\$468,518.00
Delany Road	9th Street 2700' North	2700	23	6900	82.9	\$220,800.00	\$255,604.00
5 % Annual Inflation Compounded:							\$132,224.00
Construction Cost:						\$838,841.00	\$971,065.00
8 % Engineering:						\$67,107.28	\$77,685.20
7 % Contingency:						\$58,718.87	\$67,974.55
<b>Total:</b>						<b>\$964,667.15</b>	<b>\$1,116,724.75</b>

**PROGRAMMED IMPROVEMENTS  
VILLAGE OF WADSWORTH  
2019 ROAD PROGRAM**



<b>Street</b>	<b>From To</b>	<b>Length(ft)</b>	<b>Width</b>	<b>Area (sy)</b>	<b>PCR</b>	<b>2015 Rehabilitation Cost</b>	<b>* 2019 Rehabilitation Cost</b>
Birch Lane	Cashmore Road Cul-de-Sac	613	23	1566.6	82.5	\$50,131.00	\$60,935.00
Country Lane Drive	Cashmore Road Cul-de-Sac	1302	22	3182.7	83.9	\$101,846.00	\$123,795.00
Forest View Road	21st Street Cul-de-Sac	418	20	928.9	84.1	\$29,725.00	\$36,131.00
Forest View Road	Forest View Road Waverly Street	2270	20	5044.4	84.1	\$161,421.00	\$196,208.00
Greenview Drive	Forest View Road Cul-de-Sac	2218	20	4928.9	83.7	\$157,725.00	\$191,715.00
Sheryl Lynn Drive	Kilbourne Road Cul-de-Sac	1312	23	3352.9	79.4	\$107,293.00	\$130,415.00
Timberland Trail	21st Street Greenview Drive	1637	20	3637.8	82.8	\$116,410.00	\$141,497.00
Waverly Street	Forest View Road East to Village Limit	1232	20	2737.8	83.7	\$87,610.00	\$106,490.00

**PROGRAMMED IMPROVEMENTS  
VILLAGE OF WADSWORTH  
2019 ROAD PROGRAM**



Street	From To	Length(ft)	Width	Area (sy)	PCR	2015 Rehabilitation Cost	2019 <sup>*</sup> Rehabilitation Cost
5 % Annual Inflation Compounded:							\$175,025.00
Construction Cost:						\$812,161.00	\$987,186.00
8 % Engineering:						\$64,972.88	\$78,974.88
7 % Contingency:						\$56,851.27	\$69,103.02
<b>Total:</b>						<b>\$933,985.15</b>	<b>\$1,135,263.90</b>



**PROGRAMMED IMPROVEMENTS  
VILLAGE OF WADSWORTH  
2020 ROAD PROGRAM**



<b>Street</b>	<b>From To</b>	<b>Length(ft)</b>	<b>Width</b>	<b>Area (sy)</b>	<b>PCR</b>	<b>2015 Rehabilitation Cost</b>	<b>* 2020 Rehabilitation Cost</b>
Andover Road	Killbourne Road Cul-de-Sac	1202	22	2938.2	85.1	\$94,022.00	\$119,999.00
Arbor Court	Crabapple Drive Cul-de-Sac	672	23	1717.3	86	\$54,954.00	\$70,136.00
Bluespruce Court	Oakcrest Lane Cul-de-Sac	761	20	1691.1	86	\$54,115.00	\$69,066.00
Caroline Avenue	Wadsworth Road Cul-de-Sac	400	35	1555.6	78.5	\$49,779.00	\$63,532.00
Crabapple Drive	Cashmore Road Cul-de-Sac	1234	22	3016.4	83.5	\$96,525.00	\$123,193.00
Juniper Court	Oakcrest Lane Cul-de-Sac	421	19	888.8	86	\$28,442.00	\$36,299.00
Oakcrest Lane	Cashmore Road Cul-de-Sac	3818	21	8908.7	83.5	\$285,078.00	\$363,840.00
Prairie View Drive	Andover Road Dead End	726	22	1774.7	85.1	\$56,790.00	\$72,481.00
Primrose Lane	Chicago Avenue Cul-de-Sac	1056	19	2229.3	84.8	\$71,338.00	\$91,047.00
Wedgewood Court	Prairie View Drive Cul-de-Sac	688	22	1681.8	85.1	\$53,818.00	\$68,686.00

**PROGRAMMED IMPROVEMENTS  
VILLAGE OF WADSWORTH  
2020 ROAD PROGRAM**



Street	From To	Length(ft)	Width	Area (sy)	PCR	2015 Rehabilitation Cost	2020 <sup>*</sup> Rehabilitation Cost	
5 % Annual Inflation Compounded:							\$233,418.00	
Construction Cost:							\$844,861.00	\$1,078,279.00
8 % Engineering:							\$67,588.88	\$86,262.32
7 % Contingency:							\$59,140.27	\$75,479.53
<b>Total:</b>						<b>\$971,590.15</b>	<b>\$1,240,020.85</b>	

**PROGRAMMED IMPROVEMENTS  
VILLAGE OF WADSWORTH  
2021 ROAD PROGRAM**



<b>Street</b>	<b>From To</b>	<b>Length(ft)</b>	<b>Width</b>	<b>Area (sy)</b>	<b>PCR</b>	<b>2015 Rehabilitation Cost</b>	<b>* 2021 Rehabilitation Cost</b>
Burr Oak Lane	1550 Feet South of Northwoods Shagbark Lane	1133	22	2769.6	84.2	\$88,627.00	\$118,769.00
Burr Oak Lane	Shagbark Lane 1550 Feet South	1550	22	3788.9	84.2	\$121,245.00	\$162,480.00
Golf Lane Drive	Yorkhouse Road Cul-de-Sac	1236	21	2884	85.1	\$92,288.00	\$123,675.00
Northwoods Drive	Wadsworth Road Shagbark Lane	1331	23	3401.4	84.2	\$108,845.00	\$145,862.00
Pratum Terra Drive	Delany Road Cul-de-Sac	1267	22	3097.1	86.1	\$99,107.00	\$132,813.00
Red Oak Terrace	Burr Oak Lane Dead End	1200	22	2933.3	84.2	\$93,866.00	\$125,789.00
Shagbark Lane	1550 Feet South of Northwoods Dead End	1055	22	2578.9	84.2	\$82,525.00	\$110,591.00
Shagbark Lane	Northwoods Drive 1550 Feet South	1550	22	3788.9	84.2	\$121,245.00	\$162,480.00
Shelley Lane	Burr Oak Lane Cul-de-Sac	567	23	1449	84.2	\$46,368.00	\$62,138.00

**PROGRAMMED IMPROVEMENTS  
VILLAGE OF WADSWORTH  
2021 ROAD PROGRAM**



Street	From To	Length(ft)	Width	Area (sy)	PCR	2015 Rehabilitation Cost	2021 <sup>*</sup> Rehabilitation Cost
5 % Annual Inflation Compounded:							\$290,481.00
Construction Cost:						\$854,116.00	\$1,144,597.00
8 % Engineering:						\$68,329.28	\$91,567.76
7 % Contingency:						\$59,788.12	\$80,121.79
<b>Total:</b>						<b>\$982,233.40</b>	<b>\$1,316,286.55</b>

**PROGRAMMED IMPROVEMENTS  
VILLAGE OF WADSWORTH  
2022 ROAD PROGRAM**



Street	From To	Length(ft)	Width	Area (sy)	PCR	2015 Rehabilitation Cost	* 2022 Rehabilitation Cost
Fox Glove Lane	Mill Creek Drive Goldenrod Lane	1993	23	5093.2	85	\$162,982.00	\$229,333.00
Goldenrod Lane	Kelly Road Cul-de-Sac	4376	23	11183.1	86.2	\$357,859.00	\$503,544.00
Jody Lane	Kilbourne Road Cul-de-Sac	1376	21	3210.7	87	\$102,742.00	\$144,569.00
Reed Court	Foxglove Lane Cul-de-Sac	937	22	2290.4	84.5	\$73,293.00	\$103,130.00
Sedge Court	Goldenrod Lane Cul-de-Sac	632	23	1615.1	87	\$51,683.00	\$72,723.00
Trillium Court	Goldenrod Lane Cul-de-Sac	440	21	1026.7	89.8	\$32,854.00	\$46,229.00
5 % Annual Inflation Compounded:							\$318,115.00
Construction Cost:						\$781,413.00	\$1,099,528.00
8 % Engineering:						\$62,513.04	\$87,962.24
7 % Contingency:						\$54,698.91	\$76,966.96
<b>Total:</b>						<b>\$898,624.95</b>	<b>\$1,264,457.20</b>

**PROGRAMMED IMPROVEMENTS  
VILLAGE OF WADSWORTH  
2023 ROAD PROGRAM**



Street	From To	Length(ft)	Width	Area (sy)	PCR	2015 Rehabilitation Cost	* 2023 Rehabilitation Cost
21st Street	Kilbourne Road East to Village Limit	1006	22	2459.1	79.5	\$78,691.00	\$116,263.00
21st Street	Delany Road West to Village Limit	1056	22	2581.3	79.5	\$82,602.00	\$122,040.00
Cashmore Road	Yorkhouse Road Wadsworth Road	5122	21	11951.3	83.6	\$382,442.00	\$565,040.00
Cherrywood Lane	Old Orchard Drive Cul-de-Sac	1729	19	3650.1	87	\$116,803.00	\$172,572.00
Old Orchard Drive	Mill Creek Drive Cul-de-Sac	1860	17	3513.3	87	\$112,426.00	\$166,104.00
Thornmeadow Circle	Cherrywood Lane Cul-de-Sac	618	19	1304.7	87	\$41,750.00	\$61,684.00
5 % Annual Inflation Compounded:							\$388,989.00
Construction Cost:						\$814,714.00	\$1,203,703.00
8 % Engineering:						\$65,177.12	\$96,296.24
7 % Contingency:						\$57,029.98	\$84,259.21
<b>Total:</b>						<b>\$936,921.10</b>	<b>\$1,384,258.45</b>

**PROGRAMMED IMPROVEMENTS  
VILLAGE OF WADSWORTH  
2024 ROAD PROGRAM**



<b>Street</b>	<b>From To</b>	<b>Length(ft)</b>	<b>Width</b>	<b>Area (sy)</b>	<b>PCR</b>	<b>2015 Rehabilitation Cost</b>	<b>* 2024 Rehabilitation Cost</b>
Blackhawk Trail	IL Route 173 Hidden Springs Trail	1848	22	4517.3	88.6	\$144,554.00	\$224,250.00
Cermak Avenue	Mill Creek Drive US Route 41	1267	22	3097.1	87.8	\$99,107.00	\$153,748.00
Gorham Lane	Sterling Lane Cul-de-Sac	1843	23	4709.9	87.6	\$150,717.00	\$233,811.00
Hidden Springs Trail	Cul-de-Sac Cul-de-Sac	1795	22	4387.8	87.5	\$140,410.00	\$217,821.00
High Ridge Trail	Blackhawk Trail Cul-de-Sac	1003	22	2451.8	90.6	\$78,458.00	\$121,713.00
Schlosser Court	Chicago Avenue Cul-de-Sac	1389	20	3086.7	90	\$98,774.00	\$153,232.00
Shenandoah Trail	Blackhawk Trail Cul-de-Sac	1109	22	2710.9	85.6	\$86,749.00	\$134,576.00
Sterling Lane	Russell Road Cul-de-Sac	726	23	1855.3	87.6	\$59,370.00	\$92,102.00

**PROGRAMMED IMPROVEMENTS  
VILLAGE OF WADSWORTH  
2024 ROAD PROGRAM**



Street	From To	Length(ft)	Width	Area (sy)	PCR	2015 Rehabilitation Cost	2024 <sup>*</sup> Rehabilitation Cost
5 % Annual Inflation Compounded:							\$473,114.00
Construction Cost:						\$858,139.00	\$1,331,253.00
8 % Engineering:						\$68,651.12	\$106,500.24
7 % Contingency:						\$60,069.73	\$93,187.71
<b>Total:</b>						<b>\$986,859.85</b>	<b>\$1,530,940.95</b>



**PROGRAMMED IMPROVEMENTS  
VILLAGE OF WADSWORTH  
2025 ROAD PROGRAM**



<b>Street</b>	<b>From To</b>	<b>Length(ft)</b>	<b>Width</b>	<b>Area (sy)</b>	<b>PCR</b>	<b>2015 Rehabilitation Cost</b>	<b>* 2025 Rehabilitation Cost</b>
Concord Lane	Kilbourne Road Walden Lane	1162	22	2840.4	87.6	\$90,893.00	\$148,055.00
Harmony Court	Concord Lane Cul-de-Sac	440	22	1075.6	87.6	\$34,419.00	\$56,065.00
Hart Street	Rosedale Avenue 450' East of Woodland	727	19	1534.8	91	\$49,114.00	\$80,001.00
Mill Creek Road	Foxglove Lane IL Route 173	5650	24	15066.7	86.6	\$482,134.00	\$785,346.00
Nature Court	Concord Lane Cul-de-Sac	363	22	887.3	87.6	\$28,394.00	\$46,250.00
Rosedale Avenue	Hart Street 400' North	397	17	749.9	91	\$23,997.00	\$39,088.00
Walden Lane	Cul-de-Sac Cul-de-Sac	1742	22	4258.2	87.6	\$136,262.00	\$221,957.00

**PROGRAMMED IMPROVEMENTS  
VILLAGE OF WADSWORTH  
2025 ROAD PROGRAM**



Street	From To	Length(ft)	Width	Area (sy)	PCR	2015 Rehabilitation Cost	2025 <sup>*</sup> Rehabilitation Cost
5 % Annual Inflation Compounded:							\$531,549.00
Construction Cost:						\$845,213.00	\$1,376,762.00
8 % Engineering:						\$67,617.04	\$110,140.96
7 % Contingency:						\$59,164.91	\$96,373.34
<b>Total:</b>						<b>\$971,994.95</b>	<b>\$1,583,276.30</b>

**PROGRAMMED IMPROVEMENTS  
VILLAGE OF WADSWORTH  
2026 ROAD PROGRAM**



<b>Street</b>	<b>From To</b>	<b>Length(ft)</b>	<b>Width</b>	<b>Area (sy)</b>	<b>PCR</b>	<b>2015 Rehabilitation Cost</b>	<b>* 2026 Rehabilitation Cost</b>
Boulevard View Avenue	Chaplin Street Hart Street	589	21	1374.3	91	\$43,978.00	\$75,217.00
Chaplin Street	Woodland Avenue Dale Avenue	2534	20	5631.1	88.6	\$180,195.00	\$308,195.00
Dale Avenue	Pickford Street 890' South	792	20	1760	82.8	\$56,320.00	\$96,326.00
Hart Street	Waveland Avenue Magnolia Avenue	297	20	660	91	\$21,120.00	\$36,122.00
Hart Street	Village Limit West to End	1185	21	2765	91	\$88,480.00	\$151,331.00
Magnolia Avenue	Chaplin Street Village Limit	1267	20	2815.6	91	\$90,099.00	\$154,100.00
Pickford Avenue	Bayonne Ave West End	699	22	1708.7	91	\$54,678.00	\$93,519.00
Pine Grove Avenue	Village Limit North End	1770	21	4130	91	\$132,160.00	\$226,038.00
Sylvan Avenue	Chaplin Street 365' North	377	21	879.7	87.3	\$28,150.00	\$48,147.00
Waveland Avenue	400' North of Hart Street Village Limit	1067	21	2489.7	91	\$79,670.00	\$136,263.00
Woodland Avenue	Chaplin Street South End	1109	19	2341.2	91	\$74,918.00	\$128,136.00

**PROGRAMMED IMPROVEMENTS  
VILLAGE OF WADSWORTH  
2026 ROAD PROGRAM**



Street	From To	Length(ft)	Width	Area (sy)	PCR	<b>2015</b> Rehabilitation Cost	<b>2026</b> <sup>*</sup> Rehabilitation Cost
5 % Annual Inflation Compounded:							\$603,626.00
Construction Cost:						\$849,768.00	\$1,453,394.00
8 % Engineering:						\$67,981.44	\$116,271.52
7 % Contingency:						\$59,483.76	\$101,737.58
<b>Total:</b>						<b>\$977,233.20</b>	<b>\$1,671,403.10</b>

**PROGRAMMED IMPROVEMENTS  
VILLAGE OF WADSWORTH  
2027 ROAD PROGRAM**



<b>Street</b>	<b>From To</b>	<b>Length(ft)</b>	<b>Width</b>	<b>Area (sy)</b>	<b>PCR</b>	<b>2015 Rehabilitation Cost</b>	<b>* 2027 Rehabilitation Cost</b>
21st Street	Kilbourne Road West to Village Limit	756	20	1680	89.1	\$53,760.00	\$96,545.00
21st Street	Village Limit West to End	1583	18	3166	89.1	\$101,312.00	\$181,942.00
Adams Road	RR Tracks East to Village Limit	1320	22	3226.7	90	\$103,254.00	\$185,430.00
August Zupec Drive	Delany Road West to End	1259	22	3077.6	91	\$98,483.00	\$176,862.00
Meadow Lane	August Zupec Drive Oak Knoll Drive	1293	22	3160.7	91	\$101,142.00	\$181,637.00
Northwestern Avenue	Wadsworth Road Chaplin Street	1214	21	2832.7	91	\$90,646.00	\$162,788.00
Oak Knoll Road	Delany Road Cul-de-Sac	2076	22	5074.7	91	\$162,390.00	\$291,630.00
Old Russell Road	Delany Road Cul-de-Sac	1426	22	3485.8	89	\$111,546.00	\$200,320.00

**PROGRAMMED IMPROVEMENTS  
VILLAGE OF WADSWORTH  
2027 ROAD PROGRAM**



Street	From To	Length(ft)	Width	Area (sy)	PCR	2015 Rehabilitation Cost	2027 <sup>*</sup> Rehabilitation Cost	
5 % Annual Inflation Compounded:							\$654,621.00	
Construction Cost:							\$822,533.00	\$1,477,154.00
8 % Engineering:							\$65,802.64	\$118,172.32
7 % Contingency:							\$57,577.31	\$103,400.78
<b>Total:</b>						<b>\$945,912.95</b>	<b>\$1,698,727.10</b>	

**PROGRAMMED IMPROVEMENTS  
VILLAGE OF WADSWORTH  
2028 ROAD PROGRAM**



Street	From To	Length(ft)	Width	Area (sy)	PCR	2015	2028 <sup>*</sup>
						Rehabilitation Cost	Rehabilitation Cost
August Zupec Drive	Delany Road Winchester Road	800	21	1866.7	100	\$59,734.00	\$112,638.00
Kazmer Road	Village Limit West End	1880	20	4177.8	90.6	\$133,690.00	\$252,092.00
Kelly Road	Goldenrod Lane US Route 41	2376	20	5280	100	\$168,960.00	\$318,599.00
Lester Lane	Cul-de-Sac Cul-de-Sac	968	20	2151.1	100	\$68,835.00	\$129,799.00
Martin Street	West End East End	299	19	631.2	91.5	\$20,198.00	\$38,087.00
Pine Grove Avenue	Wadsworth Road North End	1109	19	2341.2	91.5	\$74,918.00	\$141,270.00
Stiehr Road	Delany Road Cul-de-Sac	1087	19	2294.8	100	\$73,434.00	\$138,470.00
Stonegate Road	Delany Road Lester Lane	721	21	1682.3	100	\$53,834.00	\$101,511.00
Winchester Road	Wadsworth Road Cul-de-Sac	2693	21	6283.7	100	\$201,078.00	\$379,163.00

**PROGRAMMED IMPROVEMENTS  
VILLAGE OF WADSWORTH  
2028 ROAD PROGRAM**



Street	From To	Length(ft)	Width	Area (sy)	PCR	2015 Rehabilitation Cost	* 2028 Rehabilitation Cost
5 % Annual Inflation Compounded:							\$756,948.00
Construction Cost:						\$854,681.00	\$1,611,629.00
8 % Engineering:						\$68,374.48	\$128,930.32
7 % Contingency:						\$59,827.67	\$112,814.03
<b>Total:</b>						<b>\$982,883.15</b>	<b>\$1,853,373.35</b>



**PROGRAMMED IMPROVEMENTS  
VILLAGE OF WADSWORTH  
2029 ROAD PROGRAM**



<b>Street</b>	<b>From To</b>	<b>Length(ft)</b>	<b>Width</b>	<b>Area (sy)</b>	<b>PCR</b>	<b>2015 Rehabilitation Cost</b>	<b>* 2029 Rehabilitation Cost</b>
27th Place	Bayonne Avenue West End	501	20	1113.3	70.6	\$35,626.00	\$70,536.00
28th Place	Bayonne Avenue West End	589	22	1439.8	70.9	\$46,074.00	\$91,223.00
28th Street	Bayonne Avenue West End	516	20	1146.7	65.9	\$36,694.00	\$72,652.00
29th Street	Bayonne Avenue West End	583	20	1295.6	71.8	\$41,459.00	\$82,086.00
Bartlett Lane	Mauser Drive Cul-de-Sac	777	22	1899.3	85.4	\$60,778.00	\$120,335.00
Concord Court	Kilbourne Road Cul-de-Sac	2482	22	6067.1	0	\$194,147.00	\$384,398.00
Eveline Street	Wadsworth Road End	170	20	377.8	50	\$12,090.00	\$23,937.00
Mauser Drive	Delany Road Cul-de-Sac	1350	23	3450	70.9	\$110,400.00	\$218,584.00
McCarthy Road	Yorkhouse Road Sandy Court	1150	21	2683.3	70.8	\$85,866.00	\$170,008.00
Mulberry Lane	Dilleys Road Cul-de-Sac	1521	24	4056	100	\$129,792.00	\$256,979.00
Sandy Court	McCarthy Road Cul-de-Sac	645	21	1505	70.9	\$48,160.00	\$95,354.00

**PROGRAMMED IMPROVEMENTS  
VILLAGE OF WADSWORTH  
2029 ROAD PROGRAM**



Street	From To	Length(ft)	Width	Area (sy)	PCR	2015 Rehabilitation Cost	* 2029 Rehabilitation Cost
Thornapple Lane	Mulberry Lane Willow Lane	661	23	1689.2	100	\$54,054.00	\$107,024.00
Willow Lane	Cul-de-Sac Cul-de-Sac	1125	24	3000	100	\$96,000.00	\$190,073.00
5 % Annual Inflation Compounded:							\$932,049.00
Construction Cost:						\$951,140.00	\$1,883,189.00
8 % Engineering:						\$76,091.20	\$150,655.12
7 % Contingency:						\$66,579.80	\$131,823.23
<b>Total:</b>						<b>\$1,093,811.00</b>	<b>\$2,165,667.35</b>

**PROGRAMMED IMPROVEMENTS  
VILLAGE OF WADSWORTH  
2030 ROAD PROGRAM**



Street	From To	Length(ft)	Width	Area (sy)	PCR	2015 Rehabilitation Cost	* 2030 Rehabilitation Cost
9th Street	Village Limit Village Limit	1003	24	2674.7	0	\$85,590.00	\$177,936.00
Chicago Avenue	Yorkhouse Road Wadsworth Road	5544	21	12936	68.8	\$413,952.00	\$860,576.00
Helena Lane	Yorkhouse Road Cul-de-Sac	950	23	2427.8	0	\$77,690.00	\$161,511.00
Mill Creek Road	IL Route 173 350 Feet North	350	25	972.2	0	\$31,110.00	\$64,676.00
Mill Creek Road	350 Feet North of IL Route 173 Village Limit	3350	25	9305.6	0	\$297,779.00	\$619,062.00
Plaza Lane	Dilleys Road West to Village Limit	506	22	1236.9	81.3	\$39,581.00	\$82,286.00
5 % Annual Inflation Compounded:							\$1,020,345.00
Construction Cost:						\$945,702.00	\$1,966,047.00
8 % Engineering:						\$75,656.16	\$157,283.76
7 % Contingency:						\$66,199.14	\$137,623.29
<b>Total:</b>						<b>\$1,087,557.30</b>	<b>\$2,260,954.05</b>