

Ship Creek Center LLC

411 West 4th Avenue, Suite 200, Anchorage, AK 99501

Phone (907) 278-3263, Fax (907) 222-4852

Date: 17th of October 2013

To: Vendors participating in CraftAlaska

From: Property Management Team

Subject: New event registration

Dear Artisan,

CraftAlaska arts and crafts event will be held inside Ship Creek Center at 333 West 4th Avenue. Additionally, our location so near the starting line for the dogsled races makes this a natural venue for our Alaskan-made arts & crafts.

Admission is free, and the event is open to the public. The show will run from February 21 through 23, and the times are 10 a.m. to 6 p.m. daily. Our vendors pay a minimum fee of \$80 per day per table, or \$288 per table for all four days. There will be an additional 10% off for those who take advantage of our Early Bird sign up which ends November 15th. Our purpose is not to enrich the mall itself, but to provide a setting for Alaskans, Natives, and others to spotlight their merchandise during Anchorage's premier winter event.

Our permanent shops feature Native, Russian, and African arts & crafts. It seems only fitting that we highlight the best our artists have to offer, during the peak of the winter tourist season. Anchorage is a great place to live, work, and play, and we wish to help advertise that!

I look forward to your participation this year.

Sincerely,

Michael Liebner
Property Manager

Cc: J. Wong
D. Minaya



CraftAlaska 2013

Table Reservation Form

Sign up and pay prior to November 15th and receive an additional 10% off with Early Bird Rate when purchasing all 4 days!

Bring or Mail checks/money orders and completed form to:
Property Management Office, 411 W. 4th, Ste 200- located in the Sunshine Plaza (yellow bldg at 4th & D). Look at the attached Floor Map and pick where you would like to set up.

Days	Standard Table	Choice Table	Premium Table
1 day	\$80	\$90	\$100
2 day	\$155	\$175	\$194
3 day	\$223	\$251	\$279
4 day	\$288	\$324	\$360
4 Day Early Bird Discount	\$259	\$292	\$324

- I would like to reserve:
- 1st preferred table** (s) numbered # _____ on the Floor Map.
- 2nd preferred table** (s) numbered # _____ on the Floor Map.
- I would like to reserve _____ Qty of tables/suites for:
February 21, 22, 23 & March 1 or **ALL DATES** (*circle dates desired*).

Special requirements (such as electricity, vertical space, etc)

Printed Name of Vendor/Business

Phone Number

Signature of Vendor/Business

Email Address

4th AMP FLOOR PLAN

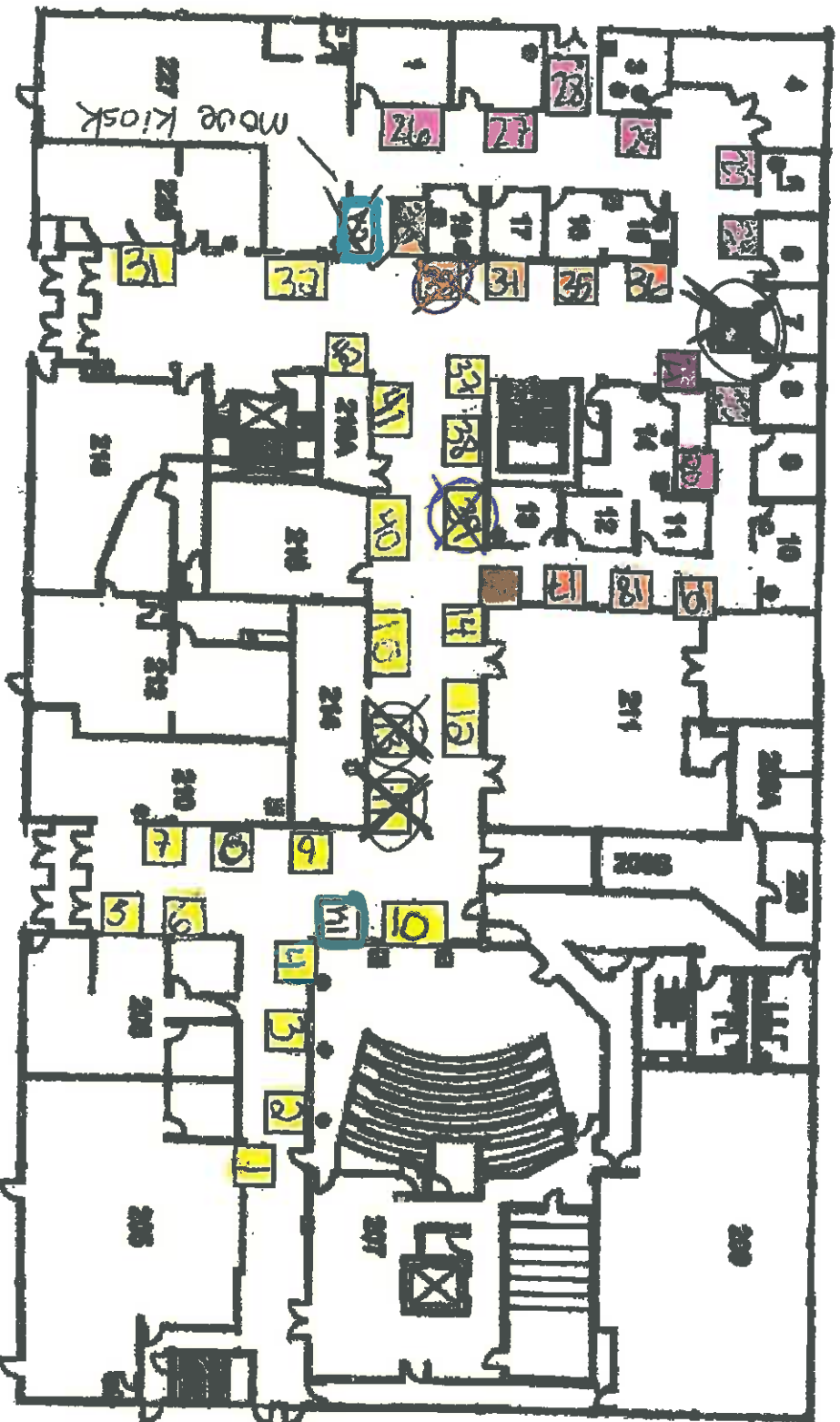

LEGEND:

Standard Outlet
Premium Outlet

Outlets are OUTSIDE the shops.

Standard
Choice
Premium