



BY HL ENTERPRISE, INC.

QUALITY PARK TRAILERS



GREAT IDEAS FOR LIVING SPACES  
LEARN MORE @  
HYLINETRAILERS.COM

IMAGINE YOURSELF ENJOYING your weekends away from the worries of the busy world. Whether it's spending quiet time by a warm and cozy fireplace with a glass of your favorite wine, or entertaining friends into the evening hours. Hy-line works with you to design YOUR perfect HOME. Why settle for less? Our Floor Plan Designs bring YOUR DREAMS to life, helping you create fond memories of quality time spent with family and friends.



# "it's exactly what we wanted"



## YOU KNOW WHAT YOU WANT...

And we're here to make it happen. Hy-Line specializes in "Flexible Designs" that result in park trailers that not only suit your needs, they exceed your expectations. We believe that a vacation or second home should be built with premium materials and high-end features, so that it doesn't just feel like home, it IS home.



**PICK YOUR FLOOR PLAN**  
 WHAT IS IMPORTANT TO YOU?

# Top Featured Floorplans

What's most important to you?

- Bunks for the kids?
- A large gourmet kitchen perfect for romantic dinners as well as entertaining friends?
- A comfy recliner set perfectly in front of a built-in entertainment center with flat screen TV... perfect for enjoying the big game with friends and family.
- Cabinets, cabinets, and more cabinets... You can never have enough space.

Choose from our most popular layouts.

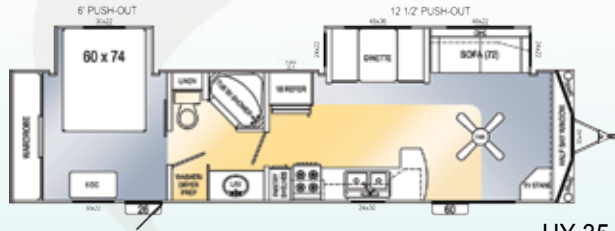

HY 35 CB1PA



HY 42 CG1PA

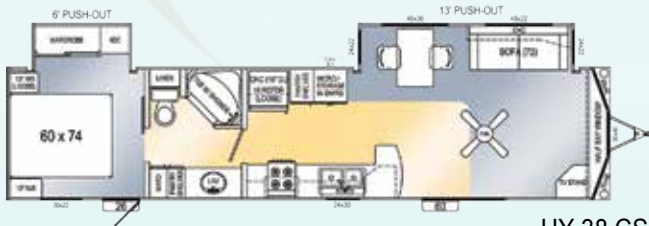

HY 38 CS1PE

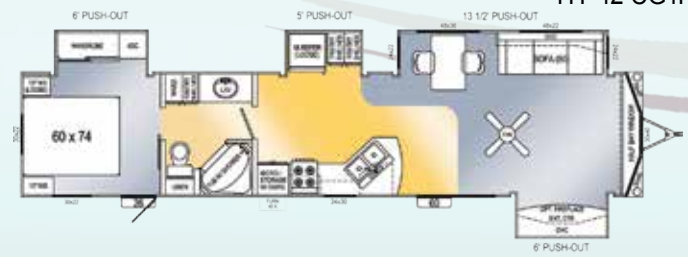

HY 42 CG1PE

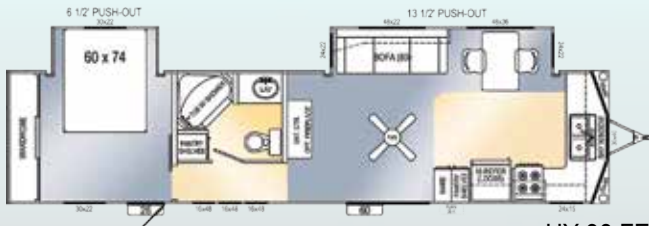

HY 38 FE1PA

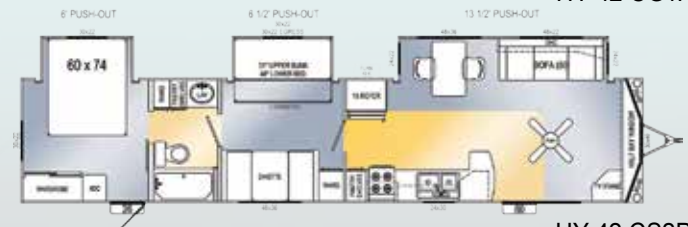

HY 42 CS2PD

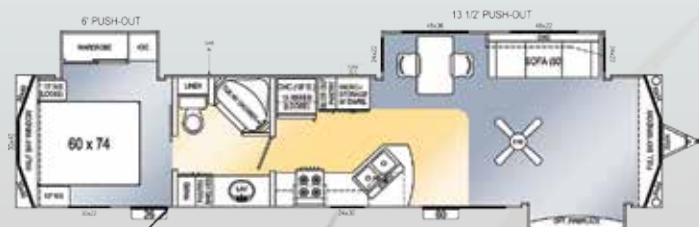

HY 39 CG1PY

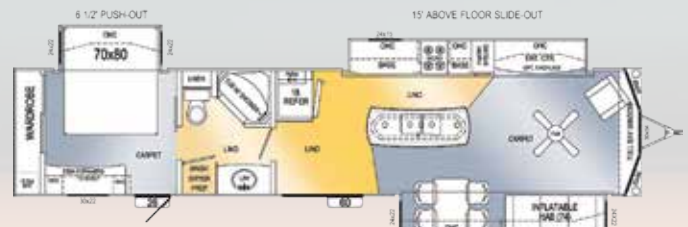

HY 42 IKWB

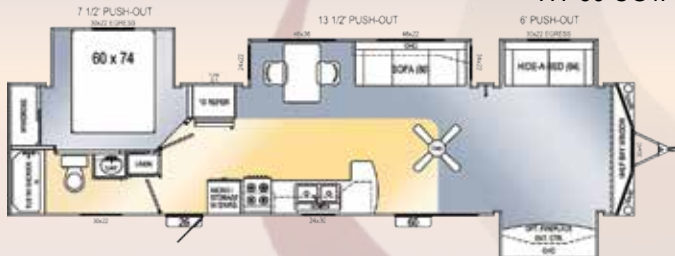

HY 39 CR2PO

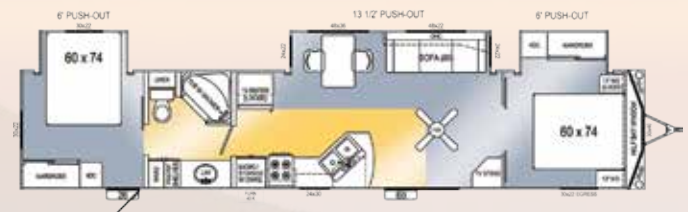

HY 44 CG2PD

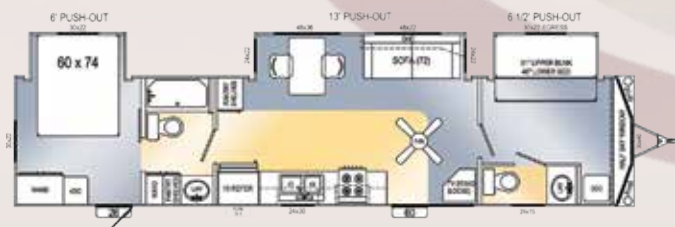

HY 39 SPEC54

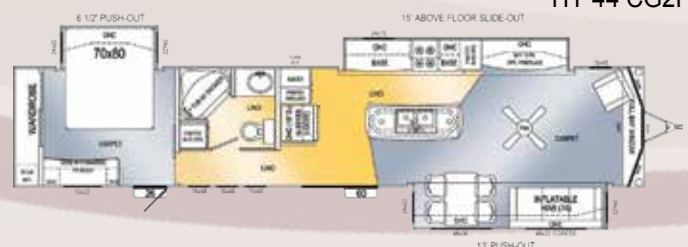

HY 44 IKEB

# Standard Features

## EXTERIOR & CONSTRUCTION FEATURES

- 96" Ceilings
- Detachable Hitch
- Spring Axles & I Beam Frame
- 2" x 4" Floor Joists with 5/8" Tongue & Groove Plywood Floor Decking
- Baton Floor & Ceiling Insulation
- Bay Front Windows
- (2) 30 lb. Bottles w/Regulators
- Flush Floor Push Outs
- 76" Patio Door
- Porch Light w/Switch
- Deluxe Graphics
- Deep Tinted Radius Windows
- Rubber Roof Membrane
- Truss Roof w/ 3/8" Decking
- Full Underbelly Wrap
- 110v GFI Outside Recept
- 50 Amp Electric Service

- 25' Electrical Supply Cord
- 110 v Lighting
- Cable TV Jacks - Living Room & Bedrooms
- City Water Hook Up

## INTERIOR FEATURES

- Wainscot & Chair Rail
- Deluxe Crown Ceiling Molding In Living Room & Kitchen
- 110v Lighting
- Residential Table & Chairs
- Large Picture Window at Dining Area
- Dinette Booth \*
- Residential Sofa
- Residential Rocker (His) \*
- Designer Bar Stools
- Queen Bed w/Lift
- 48" Bed/Twin Beds & Bunks
- Bed Spread(s)

- Full Mirrored Wardrobe \*
- Deluxe Cloth Valances w Side Drapes
- Mini Blinds
- Vertical Blinds at Patio Door
- Upgrade Congoleum Linoleum
- Shaw Plush Carpet w/Pad
- Laminated Counter Tops and Back Splashes
- Oil Rubbed Bronze Hardware
- Ball Bearing Roller Drawer Guides
- Mortise & Tenon Solid Wood Cabinet Doors
- Adjustable Pantry Shelves In Kitchen
- Ceiling Fan w/Light Kit
- Floor Ducted Heating
- Carbon Monoxide, LP & Smoke Detector

## KITCHEN, BATH & APPLIANCES

- All Black Appliances
- 18 Cu. Ft. Frost Free Refrigerator

- Deluxe Park Model Range
  - 13,500 BTU Ducted Air (32' to 29.5' Units)
  - 15,000 BTU Ducted Air (42' to 44' Units)
  - 35,000 BTU Furnace (32' to 38' Units)
  - 40,000 BTU Furnace (39.5' to 44' Units)
  - 20 Gallon Electric Water Heater w/By-Pass Plumbing
  - Fiberglass One Piece Tub/Shower
  - Residential Toilet
  - Power Bath Vent w/Switch
  - Medicine Cabinet w/Towel Bar / Towel Bar / Tissue Holder
  - Deep Double Bowl Acrylic Kitchen Sink
  - High Rise Kitchen Faucet
  - Range Hood w/Light & Fan
- Some Models\* / See Floorplans \*\**

CHOOSE  
YOUR OPTIONS  
SELECT FROM OUR MANY  
UPGRADES AND  
PREMIUM OPTIONS...  
COMPLETE  
YOUR DREAM

# Popular Options

## EXTERIOR OPTIONS

- (Gel Coat) Fiberglass Exterior
- Stabilizer Jacks
- Triple Steps
- Awning 16' - 20'
- Awning 20' - 24'
- Awning Center Support
- Power Awning
- Double Insulation Floor & Ceiling
- Thermo-Pane Windows
- Form Core Insulation
- Electric Slide Out Rooms
- Full Bay Front Windows
- Rear Bay windows
- Swing Out Grab Assist Handle
- Holding Tanks w/Monitor Panel
- Fully Self Contained
- TV Antenna w/Booster
- Thermo-Pane Patio Door
- Comfort Air Vent w/Remote
- Skylight in Shower
- Alumadome

## INTERIOR OPTIONS

- Cherry Wood Interior
- Wood Plank Linoleum
- Designer Decor Package
- Designer Box Valances
- Day / Night Shades
- Extra Interior / Exterior Recepts
- Extra Ceiling Fan
- Slide Out TV Tray
- Adjustable Pantry Shelves
- Slide Out Pantry
- Extra Wardrobe
- Extra Overhead Cabinet
- Entertainment Center
- Desk w/Drawers
- single / Double Chest

## ELECTRICAL OPTIONS

- Stereo CD Player
- DVD w/Surround Sound Bar
- Fire Place w/Remote
- 32" Flat Screen TV

- Prep for Satellite
- Extra Recept
- Phone Jack

## KITCHEN, BATH & APPLIANCE OPTIONS

- Stainless Steel Appliances
- Dishwasher (Black)
- Microwave
- Ice Maker
- Flip Up Counter Ext.
- Garden Shower w/Glass Shower Door
- Prep for Washer & Dryer
- Washer / Dryer
- Sink cover
- 15,000 BTU Ducted Air
- 2nd Roof Air
- 40,000 BTU Furnace \*
- 10 Gal. Gas / Electric Water Heater w/DSI & By-Pass
- On Demand Hot Water System

## FURNITURE OPTIONS

- Table w/2 Chairs \*
- 2 Extra Chairs
- Dinette Booth \*
- Hide-A-Bed
- Inflatable Hide-A-Bed
- Extra Hide-A-Bed
- Designer Bar Stools
- End Table / Magazine Rack
- Swivel Rocker (His)
- Standard Recliner
- Swivel Glider Recliner
- Leather Recliner w/Ottoman

## MISC OPTIONS

- Flip Floor Plan End to End
- Flip Floor Plan Side to Side
- Custom Floor Plan Charge

(\* ) Denotes Standard or Available in Some Models



BY HL ENTERPRISE, INC.

21674 BECK DRIVE ■ ELKHART, IN 46516  
574.294.1112 ■ 574.293.4672 FAX

WWW.HYLINETRAILERS.COM

HyLine complies with standards for RV ANSI #A119.2 and/or P.T. ANSI/#A119.5 and national Electrical code ANSI/NFPA #79. As well as Canadian CSA Standards. Units Compliant with other International Standards are available upon request.

■ YOUR HY-LINE DEALER ■